

## General

## ACCREDITATION

---

Allegany College of Maryland is accredited by the Middle States Commission on Higher Education, 3624 Market Street, 2nd Floor West, Philadelphia, PA 19104-2680; 267-284-5000. The Middle States Commission on Higher Education is an institutional accrediting agency recognized by the U.S. Secretary of Education and the Council for Higher Education Accreditation. The College is also accredited and approved for operation by the Maryland Higher Education Commission, 6 North Liberty Street, Baltimore, MD 21201; 1-800-974-0203. The Pennsylvania Department of Education has granted certification to the Allegany College of Maryland campus in Bedford County and to the academic programs offered.

## ACCREDITATION

---

Allegany College of Maryland is accredited by the Middle States Commission on Higher Education, 3624 Market Street, 2nd Floor West, Philadelphia, PA 19104-2680; 267-284-5000. The Middle States Commission on Higher Education is an institutional accrediting agency recognized by the U.S. Secretary of Education and the Council for Higher Education Accreditation. The College is also accredited and approved for operation by the Maryland Higher Education Commission, 6 North Liberty Street, Baltimore, MD 21201; 1-800-974-0203. The Pennsylvania Department of Education has granted certification to the Allegany College of Maryland campus in Bedford County and to the academic programs offered.

## ADMINISTRATION, FACULTY AND STAFF

---

### FULL-TIME FACULTY

---

BARMOY, MICHÈLE A. (2011)  
BIOLOGICAL SCIENCES  
BA, University of Maryland at Baltimore  
MS, Frostburg State University  
Professor

BEAL, PATRICIA L. (2024)  
NURSING  
AAS, Allegany College of Maryland  
BSN, University of Phoenix  
Assistant Professor

BONE, JOHN A. (2009)  
MULTIMEDIA TECHNOLOGY/COMPUTER TECHNOLOGY  
AAS, Allegany College of Maryland  
BIT, American Intercontinental University  
MEd, Frostburg State University  
Associate Professor  
Program Director, Multimedia Technology

BURRISS, JENNIFER R. (2021)  
NURSING  
BSN, Alderson Broaddus College  
MSN, Walden University  
RN  
LPN-RN Clinical Coordinator

CLARK, ANNETTE C. (2016)  
HUMAN SERVICE ASSOCIATE  
AA, Allegany College of Maryland  
BS, Frostburg State University  
MS, Capella University  
Licensed Clinical Alcohol and Drug Counselor  
Associate Professor  
Program Director

COCHRUM, GILBERT L. (2019)  
ENGLISH AND ACADEMIC DEVELOPMENT  
BS, Frostburg State University  
MFA, Spalding University  
Assistant Professor

CORLE, DEVON L. (2020)  
NURSING  
AS, Allegany College of Maryland

BAUGHMAN, KAREN S. (2018)  
NURSING  
AA, Allegany College of Maryland  
BSN, MSN, American Sentinel University  
RN  
Associate Professor

BOGGS, ANASTASIA L. (STACEY) (2001)  
MATHEMATICS  
AA, Potomac State College  
BA, MEd, Frostburg State University  
EdD, West Virginia University  
MA, Liberty University  
Professor

BROWN, RENATE L. (2023)  
NURSING  
AAS, Allegany College of Maryland  
BSN, Chamberlain University  
Additional graduate study at Chamberlain University  
RN  
Instructor

CALHOUN, CLORINDA R. (2013)  
MATHEMATICS  
AA, Allegany College of Maryland  
BS, Frostburg State University  
Assistant Professor

CLARK, SANDY R. (2008)  
NURSING  
AA, Allegany College of Maryland  
BSN, University of Phoenix  
MSN, Phoenix University  
RN, LNC, CRNI  
Professor  
Director of On-Campus Nursing Programs

COFIELD, RACHEL K. (2019)  
ENGLISH  
AA, Potomac State College  
BA, MA, West Virginia University  
Associate Professor

COSNER, MICHELE (2020)  
NURSING, ONLINE LPN-RN PROGRAM  
AAS, Allegany College of Maryland

BSN, MSN, Grand Canyon University  
Additional DNP study, American Sentinel University  
Assistant Professor

COURTNEY, TINA L. (2018)  
DENTAL HYGIENE  
AA, Allegany College of Maryland  
BS, Pennsylvania College of Technology  
RDH  
Assistant Professor and Clinical Coordinator

DIEHL, DAVID S. (2017)  
RESPIRATORY THERAPIST  
AAS, Allegany College of Maryland  
BS, Kaplan University  
Assistant Professor  
Director, Clinical Education

DOUTHITT, RENEE S. (2022)  
NURSING  
BSN, MSN, Chamberlain University  
RN  
Instructor

FAIRGRIEVE, STEVEN C. (2001)  
MATHEMATICS  
BS, Frostburg State University  
MS, West Virginia University  
Associate Professor

FOSTER, CASSIE F. (2020)  
BIOLOGICAL SCIENCES  
BS, Wheeling Jesuit College  
MS, West University University  
Assistant Professor  
Division Chair of Science

GAITHER, JASON A. (2021)  
HUMAN SERVICE ASSOCIATE  
AA, Allegany College of Maryland  
BSW, Frostburg State University  
MSW, Aurora University  
Assistant Professor

GASCHLER, MELODY A. (2002)  
MUSIC  
BS, Indiana University of Pennsylvania  
MEd, Frostburg State University  
Associate Professor

GIBSON, STEPHEN A. (2007)  
HISTORY  
BA, Illinois College  
MA, University of Illinois at Springfield  
PhD, St. Louis University  
Professor  
Division Chair

GRASSI, KRISTI A. (2024)  
BIOLOGICAL SCIENCES  
BS, St. Francis University  
MS, University of Medicine and Dentistry of New Jersey  
DMD, Temple University  
Associate Professor

GRIMM, CATHERINE A. (ALEX) (2021)  
OCCUPATIONAL THERAPY ASSISTANT  
AAS, Allegany College of Maryland  
BS, University of Cincinnati  
Instructor

BSN, University of Phoenix  
MSN, Regis College  
Assistant Professor

CRISLIP, COURTNEY A. (2021)  
ATHLETICS AND PHYSICAL EDUCATION  
AA, Allegany College of Maryland  
BS, MEd, Frostburg State University  
Sports Information Coordinator  
Assistant Professor

DIVELY, ASHLEY C. (2015)  
ACADEMIC DEVELOPMENT  
BS, Frostburg State University  
MA, Millersville University  
Assistant Professor  
Assistant Chair, Academic Development

DUNN, DOROTHY S. (2024)  
NURSING  
AAS, Allegany College of Maryland  
BSN, MSN, Chamberlain College of Nursing  
Assistant Professor

FISCUS, LAURA N (2009)  
ACADEMIC DEVELOPMENT  
BA, University of Pittsburgh  
MEd, Frostburg State University  
Professor  
Division Chair

FULLER, PAULA A. (1988)  
RESPIRATORY THERAPIST  
AA, Allegany College of Maryland  
BS, Salisbury University  
MEd, Frostburg State University  
RRT  
Professor  
Program Director

GALLION, JENNA L. (2000)  
ENGLISH AND SPEECH  
BS, Frostburg State University  
MA, Oklahoma State University  
Professor  
Division Chair, English (Arts and Humanities)

GEORGE, CAROLYN (2020)  
BIOLOGICAL SCIENCES/CHEMISTRY  
BS, Juniata College  
PhD, Cornell University  
Assistant Professor  
Assistant Chair of Science

GOLUB, SCOTT K. (2016)  
CRIMINAL JUSTICE/LAB COORDINATOR  
BSAS, MS, Youngstown State University  
LICDC-CS  
Associate Professor

GREISE, HEATHER M. (2016)  
Academic Development  
BA, Westminster College  
MA, West Virginia University  
Associate Professor

GROSS, BRIANNE N. (2024)  
DENTAL HYGIENE  
AAS, Allegany College of Maryland

Fieldwork Coordinator

HANSEN, KIRSTEN O. (2010)  
 MESSAGE THERAPY  
 BA, Skolen for Kropsterapi og Afspaending Copenhagen, DK  
 LMT  
 Associate Professor  
 Program Director

HENINGER, STEVEN G. (1992)  
 PHYSICS/CHEMISTRY  
 BA, University Connecticut  
 MS, Pennsylvania State University  
 Professor

HOOVER, AMANDA L. (2018)  
 MEDICAL ADMINISTRATIVE ASSISTANT/MEDICAL ASSISTANT  
 AAS, Allegany College of Maryland  
 BS, Southern New Hampshire University  
 MEd, Frostburg State University  
 Assistant Professor

HOOVER, JERRY W. (2016)  
 COMPUTER TECHNOLOGY  
 BS, Park University  
 MS, University of Phoenix  
 Associate Professor

HOSSELRODE, THEA J. (1997)  
 BUSINESS ADMINISTRATION  
 AA, Allegany College of Maryland  
 BS, MEd, Frostburg State University  
 Professor

HUBER, FREDERICK (2023)  
 CULINARY ARTS  
 AA, International Culinary Arts Institute  
 BA, MA, Stratford University  
 Associate Professor

HUNT, RAY G. (2006)  
 AUTOMOTIVE TECHNOLOGY  
 AA, Allegany College of Maryland  
 BS, Geneva College  
 Assistant Professor  
 Program Director

JACOVINO, RACHEL L. (2021)  
 NURSING, ONLINE LPN-RN PROGRAM  
 AS, Allegany College of Maryland  
 BSN, MSN, West Virginia University  
 Assistant Professor

KAISNER, KIMBERLY A. (2024)  
 NURSING  
 AAS, Allegany College of Maryland  
 BSN, Frostburg State University  
 Assistant Professor

KENTRUS, MELODY H. (2024)  
 PHYSICAL THERAPY ASSISTANT  
 BS, Frostburg State University  
 DPT, Shenandoah University  
 Associate Professor

HARVEY, MICHELLE E. (2017)  
 NURSING  
 AAS, Allegany College of Maryland  
 BS, Frostburg State University  
 DNP, University of Boise  
 Associate Professor

HEYNE, MASON (2021)  
 ATHLETICS AND PHYSICAL EDUCATION  
 BA, Rider University  
 MS, California University of Pennsylvania  
 Assistant Professor  
 Assistant Director of Student Success and Development

HOOVER, BRANDON J. (2013)  
 LEGAL STUDIES/POLITICAL SCIENCE/CRIMINAL JUSTICE  
 BS, Frostburg State University  
 JD, Ohio Northern University - Claude W  
 Pettit College of Law  
 Professor  
 Director of Criminal Justice and Legal Studies

HOPKINS, JEFFREY D. (2021)  
 OCCUPATIONAL THERAPY ASSISTANT  
 BS, University of Maryland  
 MS, University of Puget Sound  
 Associate Professor  
 Program Director

HOUSE, JAMES E. JR. (1996)  
 COMPUTER TECHNOLOGY/MULTIMEDIA TECHNOLOGY  
 AA, Potomac State College  
 BS, Frostburg State University  
 MA, West Virginia University  
 Associate Professor  
 Division Chair, Computer Technology

HUMBERTSTON, LISA D. (2017)  
 MEDICAL ADMINISTRATIVE ASSISTANT/MEDICAL ASSISTANT  
 AAS, Allegany College of Maryland  
 BS, Southern New Hampshire University  
 MEd., Frostburg State University  
 Assistant Professor  
 Program Director

IMGRUND, ROBIN L. (1994)  
 BUSINESS ADMINISTRATION/ECONOMICS  
 BS, Frostburg State University  
 MA, University of Maryland  
 Professor  
 Division Chair

JONES, DEREK S. (2018)  
 COMPUTER TECHNOLOGY, BEDFORD COUNTY CAMPUS  
 BS, University of Pittsburgh at Johnstown  
 MS, Shenandoah University  
 PhD, Indiana University of Pennsylvania  
 Professor

KELLY, MELISSA A. (2023)  
 BIOLOGICAL SCIENCES  
 BS, University of Maryland, Baltimore County  
 MS, West Virginia University  
 Master of Criminal Justice, Boston University  
 Assistant Professor

KOONTZ, TRACIE L. (2021)  
 MEDICAL LABORATORY TECHNOLOGY/PHLEBOTOMY  
 AS, Allegany College of Maryland  
 BS, MHA, University of Cincinnati  
 Associate Professor

Program Director

KWOK, WILLSON (2015)  
ANATOMY/PHYSIOLOGY  
AA, Kapiolani Community College  
BS, BA, University of Hawaii at Manoa  
MBA, PhD, University of North Carolina at Charlotte  
Professor

MARAFINO, MATHEW R. (1995)  
ENGLISH  
BA, MA, Georgetown University  
Professor

MCCOY, RILEY D. (2023)  
RESPIRATORY THERAPY ASSISTANT  
AA, Allegany College of Maryland  
Clinical Instructor

MCKENZIE, KELLY S. (2024)  
NURSING  
BSN, West Virginia Wesleyan College  
MS, LaRoche College  
Associate Professor

MCKENZIE, PATSY A. (2018)  
PSYCHOLOGY  
BS, MEd, Frostburg State University  
PhD, Walden University  
Professor

MERRILL, DEVON J. (2020)  
COMPUTER TECHNOLOGY  
BS, MS, PhD, University of California San Diego  
Associate Professor

MICHAELS, TARA L. (2023)  
NURSING  
AS, Allegany College of Maryland  
AS, Potomac State College  
BSN, West Virginia University  
Simulation Assistant  
Instructor

MORTON, BROOKE A. (2020)  
NURSING  
AA, Allegany College of Maryland  
BSN, MSN, Western Governors University  
Assistant Professor

NASSER, DONNA E. (2024)  
NURSING  
ASN, Allegany College of Maryland  
BSN, Grand Canyon University  
Instructor

OLDHAM, JEREMY G. (2010)  
PHYSICAL THERAPIST ASSISTANT  
AAS, Allegany College of Maryland  
BS, The Pennsylvania State University  
MEd, Frostburg State University  
Associate Professor

PRICE, ROBIN L. (1996)  
ART  
AA, Allegany College of Maryland

Practicum Coordinator

LEIBFREID, JOSHUA T. (2007)  
BUSINESS ADMINISTRATION  
BS, Mount Saint Mary's University  
MBA, Saint Francis University  
Assistant Professor

MCCONNELL, YVONNE A. (2023)  
NURSING  
BSN, Thomas Edison University  
MSN, Sacred Heart University  
RN  
Associate Professor

MCCOY, STEPHANIE D. (2023)  
MEDICAL ADMINISTRATIVE ASSISTANT/MEDICAL ASSISTANT  
AA, Allegany College of Maryland  
Instructor  
Assistant Program Director

MCKENZIE, MATHEW J. (2014)  
AUTOMOTIVE TECHNOLOGY  
AAS, Allegany College of Maryland  
Instructor

MCMAHON, DIANE S. (2015)  
SOCIOLOGY  
BS, Carlow University  
MA, University of Pittsburgh  
PhD, Indiana University of Pennsylvania  
Professor

MERRILL, LEX L. (2014)  
PSYCHOLOGY  
ABS, University of LaVerne  
MA, PhD, US International University  
Associate Professor

MIDDLE, JESSE A. (2024)  
NURSING  
AAS, Allegany College of Maryland  
BSN, Chamberlain College  
Instructor

MULLENAX, DANEAN R. (2020)  
DENTAL HYGIENE  
AS, AAS, Allegany College of Maryland  
BSW Frostburg State University  
RDH  
Assistant Professor

OBERT, SHERRY J. (2009)  
NURSING  
BSN, The Pennsylvania State University  
MSN, University of Maryland  
RN  
Professor

PERRIN-MILLER, MARIE L. (2012)  
FORESTRY  
AAS, Allegany College of Maryland  
BS, West Virginia University  
MS, Oregon State University  
Associate Professor  
Program Director

RAFTER, STACIE M. (2005)  
BIOLOGICAL SCIENCES  
BS, Georgia State University

BS, MEd, Frostburg State University  
Additional graduate study at Frostburg State University  
Professor

RATNAYEKE, SHYAMALA (2023)  
BIOLOGICAL SCIENCES  
BS, Bangalore University  
M.Phil, University of Peradeniya  
PhD, University of Tennessee  
Associate Professor

RHODES, EMILY F. (2024)  
OCCUPATIONAL THERAPY ASSISTANT  
AS, Allegany College of Maryland  
BS, Frostburg State University  
Fieldwork Coordinator

ROMESBERG, MELINDA J. (2003)  
NURSING  
BSN, Alderson-Broaddus College  
MS, Carlow College  
RN  
Professor

SEDDON, ROBIN E. (2004)  
EDUCATION  
BS, Slippery Rock University of Pennsylvania  
MEd, Frostburg State University  
Additional graduate study at University of Illinois and Illinois State University  
Associate Professor  
Field Placement Coordinator  
Chair, Teacher Education

SHEPHERD, TONYA A. (2010)  
ENGLISH/SPEECH  
BA, Slippery Rock University  
MA, Carnegie Mellon  
PhD, Indiana University of Pennsylvania  
Professor, English  
Assistant Chair

SISLER, LEVI E. (2022)  
FORESTRY  
BS, MS, West Virginia University  
Assistant Professor

SODERMAN, RICHARD J. (2010)  
COMPUTER TECHNOLOGY  
BS, MS, University of Rochester  
Assistant Professor

SWOPE, DEBRA A. (1997)  
HOSPITALITY MANAGEMENT  
AAS, Allegany College of Maryland  
BS, Geneva College  
MS, Indiana University of Pennsylvania  
Assistant Professor  
Program Director

THOMPSON, CODY D. (2011)  
MATHEMATICS  
AA, Allegany College of Maryland  
BS, Frostburg State University  
MS, Indiana University of Pennsylvania

MEd, George Washington University  
Associate Professor

REAMS, TOMMIE D. (2013)  
ATHLETICS AND PHYSICAL EDUCATION  
AS, Allegany College of Maryland  
BS, MEd, Frostburg State University  
MA, Ball State University  
Associate Professor  
Director of Athletics, Physical Education and Health

ROHRBAUGH, STACEY L. (1989)  
MEDICAL LABORATORY TECHNOLOGY  
BS, West Virginia University  
MT (ASCP)  
CLS (NCA)  
MEd, Frostburg State University  
Professor  
Program Director

SANFORD, DAVID L. (1998)  
CULINARY ARTS  
AOS, Culinary Institute of America  
Instructor  
Program Coordinator

SENKA, STACY F. (2020)  
MEDICAL ADMINISTRATIVE ASSISTANT/MEDICAL LABORATORY  
TECHNOLOGY/PHLEBOTOMY-LABORATORY ASSISTANT  
AA, Allegany College of Maryland  
BS, University of Louisiana, Monroe  
Instructor

SHORE, MARK A. (1994)  
MATHEMATICS  
BS, MS, Frostburg State University  
EdD, West Virginia University  
Professor  
Division Chair

SMEARMAN, ELIZABETH M. (2019)  
NURSING  
AS, Allegany College of Maryland  
BSN, Kaplan University  
MSN, Purdue Global University  
Instructor

SUTER, JENNIFER D. (2021)  
NURSING  
AA, Potomac State College  
AAS, Allegany College of Maryland  
BSN, West Virginia University  
MSN, Capella University  
Associate Professor

TASKER-BOUCOT, BRENDA J. (2021)  
NURSING  
AS, Shenandoah University  
BSN, MSN, Frostburg State University  
Assistant Professor

THOMPSON, JENNIFER E. (2013)  
DENTAL HYGIENE  
AA, Allegany College of Maryland  
BSDH, Pennsylvania College of Technology  
MHL, Park University

Assistant Professor

THOMPSON, KATHLEEN G. (2002)  
BIOLOGICAL SCIENCES  
BS, Pennsylvania State University  
PhD, Thomas Jefferson University  
Professor

TURNER, TIMOTHY T. (1996-2001; 2008)  
BIOLOGICAL SCIENCES  
BS, MEd, Frostburg State University  
Associate Professor

WAKEFIELD, CATHY B. (2003)  
DENTAL HYGIENE  
AA, Allegany College of Maryland  
BS, West Virginia University  
MEd, Frostburg State University  
Associate Professor  
Program Director

WHITE, KARISA R. (2017)  
NURSING  
ASN, Allegany College of Maryland  
BSN, MSN, Kaplan University  
DNP, Grand Canyon University  
Assistant Professor

YOUNKIN, AIMEE L. (2003)  
NURSING, ONLINE LPN-RN PROGRAM  
BSN, MSN, Carlow University  
PhD, Capella University  
RN  
Professor  
Director of Online Nursing Programs

Associate Professor

TUMMINO, KATHY L. (2018)  
EDUCATION  
BA, MS, PhD, Hood College  
Professor  
Assistant Chair

VICKORY, SAMANTHA R. (2019)  
NURSING  
AA, Allegany College of Maryland  
BSN, Frostburg State University  
MSN, University of Maryland, Baltimore  
Additional study DNP, University of Maryland, Baltimore  
RN, MSN  
Associate Professor

WALCH, MELISSA A. (2020)  
NURSING  
BSN, University of Phoenix  
MSN, Walden University  
RN  
Associate Professor

WILFONG, TINO G. (2015)  
ENGLISH  
BA, University of Pittsburgh, Johnstown  
MA, PhD, Indiana University of Pennsylvania  
Associate Professor

**PROFESSOR EMERITA/EMERITUS**

A'HEARN, BETTIE C. (1988-2017)  
PHYSICS  
BS, EdD, West Virginia University  
MS, Marshall University  
Professor

BAKER, THOMAS C. (1969-2007)  
BIOLOGICAL SCIENCES  
BS, MS, Brigham Young University  
EdD, University of Maryland  
Additional graduate study at University of Kansas and Utah State University  
Professor

BROWN, MAUREEN M. (2001-2018)  
EDUCATION  
BS, MEd, Frostburg State University  
Additional graduate study at West Virginia University and Frostburg State University  
Associate Professor  
Division Coordinator

CONES, WILLIAM L. (1970-1995)  
FORESTRY  
BSF, West Virginia University  
MF, Duke University  
PhD, West Virginia University  
Professor

COSTELLO, DEBORAH A. (1980-2018)  
NURSING  
AA, Allegany College of Maryland

ANDREWS, PATRICIA S. (1968-2007)  
BIOLOGICAL SCIENCES  
BS, MEd, Frostburg State University  
Additional graduate study at Frostburg State University  
Professor

BRADY, W. PATRICK (1985-1987; 1992-2008; 2015-2016)  
BUSINESS ADMINISTRATION  
BA, University of Pittsburgh  
MBA, Frostburg State University  
CPA  
Professor

BUCKLEY, MARY C. (1970-1992)  
ENGLISH  
AB, College of Notre Dame of Maryland  
MA, Duquesne University  
Additional study at West Virginia University  
Assistant Professor

COOK, JANET S. (1975-2001)  
ENGLISH/SPEECH  
BS, MEd, University of Nebraska  
Additional graduate study at Frostburg State University  
Professor

DOUGAN, STANLEY J. (1965-1994)  
GEOGRAPHY/POLITICAL SCIENCE/CRIMINAL JUSTICE  
BS, Southeast Missouri State University

BSN, MSN, University of Maryland  
RN  
Professor  
Program Director

ETCHISON, CRAIG (1993-2008)  
ENGLISH  
BA, Lynchburg College  
MA, Shippensburg University  
PhD, Indiana University of Pennsylvania  
Professor

HOTT, SHARON C. (1963-2000)  
PSYCHOLOGY  
RN, Memorial Hospital of Nursing  
BS, Concord College  
MA, EdD, West Virginia University  
Additional graduate study at Columbia University  
Professor

JASTRZEMBSKI, JOHN P. (1994-2019)  
FOREST TECHNOLOGY  
LPF, AS, Nassau Community College  
BS, State University of New York College of Environmental Science and Forestry  
MS, University of New Hampshire  
Professor  
Division Chair, Sciences

KERSHAW, CAROLYN G. (1975-2005)  
ENGLISH/SPEECH/READING  
BS, MA, West Virginia University  
Additional graduate study at West Virginia University  
Professor

MARKEY, E. LOWELL (1988-2008)  
POLITICAL SCIENCE  
BA, Lycoming College  
MS, University of Louisville  
JD, West Virginia University  
Additional study at Wright State University  
Professor

MELLON, JAMES E. (1967-1986)  
PHYSICS/MATHEMATICS/ENGINEERING  
BA, Frostburg State University  
MS, University of Wisconsin/Milwaukee  
Professor

POWERS, JOSEPHINE A. (1976-2011)  
DENTAL HYGIENE  
BS, West Virginia University  
MEd, Frostburg State University  
Professor

REUSCHLEIN, G. VICTOR (1992-2006)  
CRIMINAL JUSTICE  
AA, Frostburg State University  
JD, University of Baltimore/Eastern College  
Professor

SHAFFER, GARY D. (1983-2008)  
MATHEMATICS  
BS, MEd, Shippensburg University  
Professor

MA, Marshall University  
Additional graduate study at Mississippi State University and the University of Alabama  
Associate Professor

HELSEL, MERLE W. (2001-2015)  
BUSINESS ADMINISTRATION  
BS, The Pennsylvania State University  
JD, Dickinson School of Law  
Professor

HOWELL, JAMES A. (1977-2017)  
BIOLOGICAL SCIENCE  
BA, MS, PhD, Miami University of Ohio  
Additional graduate study at Frostburg State University and West Virginia University  
Professor

KELLER, MARGARET B. (1968-1992)  
NURSING  
AB, Central Bible College  
MS, University of Maryland  
RN  
Associate Professor

LEIBFRED, FRANCES K. (1982-2016)  
INSTRUCTIONAL AFFAIRS  
BSN, West Virginia University  
MEd, Saint Francis College  
RN  
Professor

MASTRANGELO, MOLLY F. (1987-1996)  
BIOLOGICAL SCIENCES  
BA, Mount Holyoke College  
Graduate study at University of Stockholm, Sweden  
PhD, Yale University  
Additional study at The National Institute of Health, Catholic University, The George Washington University  
Professor

NEFF, CYNTHIA K. (1983-2016)  
NURSING  
BSN, MSN, University of Maryland  
RN  
Professor

RESH, STEVE F. (1986-2018)  
FOREST TECHNOLOGY  
BS, Pennsylvania State University  
MS, University of Maine  
Professor  
Program Coordinator

SAUNDERS-BLOOM, MOLLY H. (1976-2011)  
MEDICAL LABORATORY TECHNOLOGY  
BS, West Virginia University  
MT (ASCP)  
CLS (NCA)  
MEd, Frostburg State University  
Professor

SHREVE, JACK J. (1975-2007)  
ENGLISH/SPANISH  
BA, Pennsylvania State University  
MA, PhD, University of Pittsburgh  
Additional study at University of Salamanca, Spain, The University of Texas at Austin, (NEH Fellow), The George Washington University, University of California at Santa Cruz (NEH Fellow), and University of Chicago (NEH Fellow)



SNYDER, CHERIE L. (1987 - 2021)  
HUMAN SERVICE ASSOCIATE  
BA, Dickerson College  
MSS, Bryn Mawr College  
MA, University of Pennsylvania  
Certification in Mind/Body Skills, Center for Mind/Body Medicine,  
Washington, D.C.  
Professor  
Program Director

WILCOX, BEVERLY A. (1976-2018)  
ENGLISH/SPEECH/LEADERSHIP  
BS, MA, EdD, West Virginia University  
Additional graduate study at University of Maryland  
Professor

WINNER, JIM P. (1981-1999)  
MATHEMATICS  
BS, Frostburg State University  
MTS, College of William and Mary  
Professor

ZAMAGIAS, JAMES D. (1964-2007)  
ENGLISH  
BA, University of Pittsburgh  
Additional graduate study at Pennsylvania State University  
Professor

Professor

STICKLER, JAMES D. (1986-2013)  
BIOLOGICAL SCIENCES/CHEMISTRY  
BS, West Virginia University  
MS, PhD, University of Kentucky  
BA, Morris Harvey College  
CAS, West Virginia College of Graduate Studies  
Professor

WILLIAMS, BARBARA (1971-1995)  
NURSING  
BS, MEd, Frostburg State University  
Additional graduate study at the University of Maryland  
RN  
Associate Professor

WORKMAN, JR., GLENN O. (1968-1992)  
BIOLOGICAL SCIENCES  
AA, Potomac State College  
BS, MS, PhD, West Virginia University  
Additional graduate study at North Dakota State University  
Professor

ZUMBRUN, CYNTHIA M. (2001-2023)  
MEDICAL ADMINISTRATIVE ASSISTANT/MEDICAL ASSISTANT  
AA, Allegany College of Maryland  
BS, Med, Frostburg State University  
Professor  
Assistant Program Director

## ADMINISTRATIVE AND PROFESSIONAL SUPPORT STAFF

BEALL, ANDREA M. (2024)  
DIRECTOR OF PUBLIC RELATIONS AND MARKETING  
BS, Frostburg State University

BECKER, AUTUMN M. (2010)  
DIRECTOR OF THE WESTERN MARYLAND IT CENTER OF  
EXCELLENCE  
BS, MA, Frostburg State University

BOHN, SARAH K. (2023)  
COORDINATOR BASIC ADULT EDUCATION  
AA, Allegany College of Maryland  
BS, Frostburg State University

BOONE, TIFFANY M. (2003)  
COORDINATOR FOR EARLY COLLEGE/COLLEGE AND CAREER  
COACH  
AA, Allegany College of Maryland  
BS, Geneva College

BROWELL, GRANT M. (2022)  
FORESTRY TECHNICIAN  
AA, Allegany College of Maryland

BUFFENMYER, SHERRY L. (1990)  
DIRECTOR OF FISCAL AFFAIRS  
BS, Frostburg State University

CESSNA, LEROY A. (2003)  
COORDINATOR OF TRANSPORTATION  
Certificate, Automotive Technology, Allegany College of Maryland

BECK, EMILY L. (2024)  
PAYROLL ADMINISTRATOR  
AS, Allegany College of Maryland  
BS, Frostburg State University

BENNETT, CHELSEY R. (2018)  
ADMISSIONS AND SCHEDULING COORDINATOR  
AS, Allegany College of Maryland  
BS, Potomac State College of West Virginia University

BONARIGO, SHEA A. (2006)  
CONTINUING EDUCATION AND WORKFORCE DEVELOPMENT  
OPERATIONS MANAGER OF FINANCE & REGISTRATION  
AA, Potomac State College  
BA, Potomac State College of West Virginia University

BOWMAN, SARAH K. (2023)  
CONTINUING EDUCATION COORDINATOR OF CAREER & EMPLOYER  
SOLUTIONS  
Certificate, Allegany College of Maryland  
BS, Frostburg State University

BROWNING, BARBARA A. (1996)  
TECHNICAL SERVICES/REFERENCE LIBRARIAN  
BS, Frostburg State University  
MLIS, Louisiana State University

BURNSIDE, SHANNON D. (2018) (Part-time)  
GRAPHIC DESIGNER  
Undergraduate study at the Art Institute of Pittsburgh and Allegany College  
of Maryland

CHAPMAN, MELANIE J. (2016)  
CONTINUING EDUCATION DIRECTOR OF CAREER AND  
PROFESSIONAL EDUCATION  
BS, Frostburg State University  
MEd, University of Phoenix

CLARK, ANDREW D. (2024)  
FACILITIES PLANNER & COLLEGE RISK MANAGER  
AA, Allegany College of Maryland

COFIELD, RICHARD O. (2016)  
ADVISEMENT COORDINATOR PATHWAYS FOR SUCCESS (TRiO SSS)  
AA, Potomac State University  
BA, MA, West Virginia University

COOK, LUANNE (2021)  
COORDINATOR OF CAREER & TECHNICAL EDUCATION  
AA, Tidewater Community College  
BS, Fairmont State University  
MS, University of Maryland Global Campus

CRAWFORD, SHERMAN (RICH) (1990)  
DEAN OF INFORMATION TECHNOLOGY  
AA, Allegany College of Maryland  
BS, MBA, Frostburg State University

DEFIBAUGH, LANDON T. (2020)  
STUDENT SERVICES SPECIALIST, BEDFORD COUNTY CAMPUS  
AS, Allegany College of Maryland  
BS, St. Francis University

DEVORE, TARA L. (2010)  
DIRECTOR OF PATHWAYS FOR SUCCESS (TRiO SSS)  
BA, University of Pittsburgh at Johnstown  
MEd, Frostburg State University

DUCKWORTH, MELINDA K. (2008)  
DIRECTOR OF HUMAN RESOURCES  
BS, MBA, Frostburg State University

EVANS, SUSAN E. (2000)  
HELPPDESK COORDINATOR  
AA, Allegany College of Maryland

FORD, CARRIE J. (2002)  
STUDENT FINANCIAL AID COORDINATOR OF CAMPUS-BASED  
PROGRAMS  
AS, Allegany College of Maryland  
BS, MS, Geneva College

GEIL, GERALD R. (2004)  
COORDINATOR ACADEMIC ACCESS AND DISABILITY RESOURCES  
BA, Marietta College  
Additional graduate study at Marietta College

GETZ, JOSHUA D. (2006)  
MARKETING AND ALUMNI SPECIALIST  
AA, Potomac State College  
BAE, Fairmont State University

GRIMM, C. LYNN (1995)  
ADMINISTRATIVE COORDINATOR OF CAREER EDUCATION  
AA, Allegany College of Maryland

HAY, MATTHEW D. (2008)  
CATALOGING/REFERENCE LIBRARIAN  
AA, Allegany College of Maryland  
BA, Frostburg State University  
MLIS, University of Pittsburgh

HENSON, DEBORAH E. (2022)

CLARK-TRUB, DIONE L. (2018)  
DIRECTOR OF LEARNING COMMONS  
AS, Allegany College of Maryland  
BS, Frostburg State University  
Graduate Certificate, University of Maryland  
MS, Capella University

CONNER, B. RENEE (2005)  
DEAN OF STUDENT AND LEGAL AFFAIRS  
BA, Washington College  
JD, TC, University of Virginia

COOPER, PAUL E. (RICK) (1994)  
NURSING  
AA, Allegany College of Maryland  
BSN, MSN, West Virginia University  
RN  
Program Administrator  
Director of Nurse Managed Wellness Clinic  
Associate Dean of Nursing

DAWSON, AMIE M. (2024)  
STUDENT SUPPORT COORDINATOR  
BS, Davis & Elkins College  
MA, Liberty University

DEPREY, PATRICE M. (2021)  
CONTINUING EDUCATION, ADULT EDUCATION AND LITERACY  
SERVICES, COORDINATOR OF MIS  
BA, University of Maine

DIEHL, MAKENNIA C. (2024)  
ACCOUNTING BUDGETING  
BS, Seton Hill University

ENGELBACH, JENNIFER L. (1996)  
DEAN OF ENROLLMENT AND EDUCATIONAL SERVICES  
AA, Allegany College of Maryland  
BS, MS, Geneva College

FEASTER, LEVI J. (2015)  
MULTIMEDIA PRODUCTION SPECIALIST/eLEARNING & EDUCATION  
TECHNOLOGY SERVICES  
BS, Pensacola Christian College

FREIDENBLOOM, JOY L. (2016)  
LAB COORDINATOR  
BS, Pennsylvania State University

GEORGE, GABRIEL T. (2003)  
TRANSFER COORDINATOR AND SUCCESS COACH  
AA, Allegany College of Maryland  
BS, Frostburg State University

GIBSON, RENEE L. (2019)  
DIRECTOR OF STUDENT SUPPORT AND EDUCATION  
BS, California University of Pennsylvania

HARRAH, SCOTT T. (2011)  
ASSOCIATE DEAN OF INSTITUTIONAL EFFECTIVENESS, RESEARCH  
AND PLANNING  
BS, Frostburg State University  
MA, University of Pittsburgh

HENSLEY, SARAH L. (2015)  
LICENSED CERTIFIED ATHLETIC TRAINER  
BS, MS, Shenandoah University

HOFFMAN, KURT W. (2000)

COORDINATOR OF ALLIED HEALTH TECHNICIAN PROGRAMS  
AA, Hagerstown Community College  
BA, MS, Hood College  
Doctoral student, University of Miami

HOLT, KAREN RENAE (2021)  
ACCOUNTANT, GRANTS AND HOUSING  
AA, Allegany College of Maryland  
BS, Frostburg State University

JENSEN, COURTNEY B. (2021)  
DIRECTOR OF GRANTS AND DEVELOPMENT & EXECUTIVE  
DIRECTOR OF ALLEGANY COLLEGE OF MARYLAND FOUNDATION  
BA, Messiah University

KEHRWALD, KRISTIN L. (2018)  
COMMUNICATIONS COORDINATOR  
BS, MEd, Frostburg State University

KILDUFF, CHRISTINA S. (2016)  
VICE PRESIDENT OF FINANCE AND ADMINISTRATION  
BS, Mount St. Mary's College  
MBA, Frostburg State University  
CPA, CGMA

KNOPSNIDER, MATTHEW K. (2012)  
COORDINATOR OF TECHNICAL SERVICES  
AAS, Allegany College of Maryland

KRAVETS, TINA L. (2020)  
COLLEGE AND CAREER COACH, BEDFORD COUNTY CAMPUS  
BS, Liberty University  
MEd, University of Virginia

LASHBAUGH, JENNIFER R. (2012)  
SENIOR GRANTS ACCOUNTANT  
BS, Frostburg State University

LECHNER, RYAN (2024)  
RESIDENCE LIFE AREA COORDINATOR  
BS, Missouri Southern State University  
MA, University of Queensland

LITTLE, BETH E. (2025)  
CHIEF ADVANCEMENT AND COMMUNITY RELATIONS OFFICER  
BA, Alderson-Broaddus College  
MA, George Washington University

MARSH, JACKIE L. (1986)  
COORDINATOR OF ENTERPRISE SERVICES  
AA, Allegany College of Maryland

MCKENZIE, COREY E. (2024)  
ASSISTANT DIRECTOR OF CAMPUS SAFETY AND SPECIAL POLICE

MILLER, LINDSAY M. (2023)  
VIRTUAL SUCCESS AND RETENTION COACH  
BA, West Virginia University  
Ms, Geneva College

MONTANA, HOLLY (2024)  
FINANCIAL AID COUNSELOR  
BS, Frostburg State University

SENIOR VICE PRESIDENT OF INSTRUCTIONAL AND STUDENT  
AFFAIRS  
AA, Scottsdale Community College  
BS, Arizona State University  
MA, Sonoma State University  
EdD, Frostburg State University

IMES, TINA M. (2005)  
DIRECTOR OF THE BEDFORD COUNTY CAMPUS AND STUDENT  
SERVICES  
AS, Central Penn Business College  
BS, Geneva College

JONES, DAVID R. (1996)  
PRESIDENT  
BS, MEd, Frostburg State University

KERNS, WILLIAM J. (2023)  
COLLEGE AND CAREER COACH  
AA, Allegany College of Maryland  
BA, Frostburg State University

KING, SHYANN N. (2022)  
BUSINESS OFFICE DIRECTOR  
BS, Frostburg State University

KNOPSNIDER, WENDY (2016)  
PROGRAMMER ANALYST  
AA, Garrett College  
AS, Allegany College of Maryland

LANCASTER, DAVID M. (2009)  
DIRECTOR OF CAMPUS SECURITY AND SPECIAL POLICE  
Maryland Correctional Training Academy

LASHBAUGH, KATHLEEN (KASS) F. (1998)  
SYSTEMS PROGRAMMER ANALYST  
BS, Frostburg State University

LIGHT, JENNIFER P. (2017)  
PROGRAM DIRECTOR OF INDUSTRIAL TECHNOLOGIES  
BA, Virginia Polytechnic Institute & State University  
PhD, West Virginia University

MARINI, JORDAN N (2024)  
COLLEGE RECRUITER  
BS, Towson University

MCINROY, THOMAS R. (2023)  
DEAN OF CONTINUING EDUCATION AND WORKFORCE  
DEVELOPMENT  
BA, Mansfield University  
MA, Shippensburg University  
PhD, Widener University

MCLEOD, MARI-JANE (GRACIE) (2024)  
CONTINUING EDUCATION, ADVANCED MANUFACTURING PROJECT  
MANAGER  
BA, MA, West Virginia Wesleyan College

MILLER, TAMMY J. (2016)  
DIRECTOR OF eLEARNING & EDUCATION TECHNOLOGY SERVICES  
BS, Lebanon Valley College  
MA, George Washington University

MOUSE, KIMBERLY S. (2007)  
COORDINATOR OF PUBLIC RELATIONS AND ADVANCEMENT  
SERVICES  
BS, Shepherd College

NORRIS, HUNTER M. (2023) (Part-time)  
SECURITY GUARD, CAMPUS  
AS, BS, Potomac State College

O'DONNELL, JAMES (2023)  
WEB APPLICATION DEVELOPER  
BS, Geneva College

ORNDOFF, JESSICA (2024)  
CONTINUING EDUCATION COORDINATOR, PROGRAM MANAGER  
CULTURE OF CARE & RESILIENCE INSTITUTE  
BS, Towson University  
MS, University of Maryland

PALUMBO, MEGHAN S. (2003-2004; 2005)  
DIRECTOR OF FINANCIAL AID  
BS, Towson University

PERDEW, JAMES R. (2019)  
ASSISTANT ATHLETIC DIRECTOR OF RECRUITMENT, FUNDRAISING,  
COMMUNITY RELATIONS  
AA, Allegany College of Maryland  
BS, MEd, Frostburg State University

PHIPPS, ADAM D. (2012)  
DIRECTOR OF PHYSICAL PLANT  
AA, Saint Francis University

PRATT, JOHN D. (Mo) (2023)  
COLLEGE RECRUITER AND DEVELOPMENT ASSOCIATE  
AA, Allegany College of Maryland  
BS, Frostburg State University

PRICE, AMY L. (2009)  
STUDENT FINANCIAL AID STUDENT LOAN COUNSELOR  
AA, Allegany College of Maryland  
BS, Towson University

PYLES, CHRISTOPHER L. (2017)  
SYSTEMS ADMINISTRATOR  
AAS, Allegany College of Maryland

REESE, THERESA H.Z. (2017)  
COLLEGE AND CAREER COACH  
BA, University of Pittsburgh  
MA, Simmons College

RITCHEY, JARED L. (2012)  
EDUCATION TECHNOLOGY COORDINATOR, eLEARNING &  
EDUCATION TECHNOLOGY SERVICES  
AAS, Allegany College of Maryland  
BA, Frostburg State University  
MET, Boise State University

ROBINETTE, BRANDON L. (2015)  
BUDGET COORDINATOR  
AA, Allegany College of Maryland  
BS, University of Phoenix

SAVAGE, KARIN E. (2009)  
DEAN OF CAREER PROGRAMS  
BS, California University of Pennsylvania  
DPT, Slippery Rock University

SECRETI, MICHAEL A. (2022)  
RESIDENCE LIFE AREA COORDINATOR  
BA, Felician University  
MEd, Merrimack College

SMARIK, DAVID M. (2018)

NIGHTENGALE, ELIZABETH C. (2005)  
DIRECTOR OF ENROLLMENT AND ADVISING SERVICES/REGISTRAR  
AS, Allegany College of Maryland  
BS, Frostburg State University  
MS, Geneva College

OROURKE, SHAWN C. (2025)  
DIRECTOR OF WESTERN MARYLAND WORKS

PAAPE, VALERIE C. (2010)  
ACCOUNTANT, COLLEGE AND FOUNDATION  
AA, Garrett College  
BS, MBA, Frostburg State University

PEPPLE, LEAH M. (2002)  
DIRECTOR OF PENNSYLVANIA ADVANCEMENT AND COMMUNITY  
RELATIONS  
BS, Duquesne University  
MS, Geneva College

PHILLIPS, ALICIA M. (2017)  
SENIOR GRAPHIC DESIGNER  
BS, Frostburg State University

POTTS, DAVID W. (1998)  
NETWORK AND SECURITY ENGINEER  
AAS, Allegany College of Maryland

PRIADKIN, ARTHUR D. (2015)  
RESEARCH ANALYST  
BS, George Washington University  
MBA, Frostburg State University

PRICE, JENNA C. (2008)  
ACCOUNTS PAYABLE OFFICER MANAGER  
AS, AAS, Allegany College of Maryland

REDMAN, SHANNON N. (2004)  
DIRECTOR OF DESIGN, PRINT & MAIL SERVICES  
BFA, Frostburg State University  
Graduate study at Savannah College of Art and Design

RICE, CARLA A. (2004)  
CAMPUS STORE MANAGER  
AAS, Allegany College of Maryland  
BS, University of Maryland University College

RIVERS, LAURA J. (2019) (Part-time)  
COORDINATOR OF WESTERN MARYLAND WORKS  
AA, Allegany College of Maryland  
BA, Frostburg State University

SADLIER, LORI M. (2017)  
COORDINATOR OF THE WORKFORCE EXPERIENCE PROGRAM (WEX)  
BS, Frostburg State University  
MBA, University of Phoenix

SCOTT, SARAH J. (2023)  
SPECIAL POLICE OFFICER SERGEANT  
AA, Allegany College of Maryland

SIVIC, JOHN R. (2000)  
ACADEMIC LAB COORDINATOR  
AA, Allegany College of Maryland

SMITH, TERRI A. (1997)

CONTINUING EDUCATION COORDINATOR OF TRANSPORTATION AND BUSINESS OFFICE MANAGER  
SAFETY  
BA, MEd, Frostburg State University

BA, Potomac State College

SNYDER, CHRISTA A. (2001)  
CONTINUING EDUCATION HEALTH AND HUMAN SERVICES  
COORDINATOR  
AA, Allegany College of Maryland  
BS, MEd, Frostburg State University

SPENCE, LORI H. (2001)  
EXECUTIVE ASSOCIATE TO THE PRESIDENT AND BOARD OF  
TRUSTEES  
BS, MBA, Frostburg State University

STALLINGS, BETH (2020)  
EDUCATIONAL SPECIALIST (TRiO/SSS)  
BS, Frostburg State University  
MS, West Virginia University

TAYLOR, NICHOLAS E. (2002)  
DIRECTOR OF APPLICATION SERVICES  
AA, Potomac State College  
BS, MS, West Virginia University

THOELE, MELINDA M. (2014) (Part-time)  
ACCOMMODATION SPECIALIST, ACADEMIC ACCESS AND DISABILITY  
RESOURCES  
AS, Lincoln Land Community College  
BS, University of Illinois at Springfield  
MS, Saint Louis University

TOMLINSON, ALLISSA M. (2014)  
CONTINUING EDUCATION, COORDINATOR OF COMMUNITY AND  
LIFELONG ENGAGEMENT  
LOR, AA, Allegany College of Maryland  
RBA, West Virginia University Potomac State College

VERBA, TINA L. (2014)  
LEAD SUCCESS AND CAREER COACH  
BA, Slippery Rock University  
MS, Capella University

WARNICK, JUSTIN D. (2018)  
WEB AND MEDIA DESIGN SPECIALIST  
AA, Allegany College of Maryland  
BFA, Frostburg State University

WESTFALL, KATRINA (2023)  
SUCCESS & RETENTION COACH  
BA, Glenville State College  
MA, Frostburg State University

WESTFALL, SHANESE M. (2015)  
HUMAN RESOURCES GENERALIST  
AA, Potomac State College  
BS, West Virginia University  
MS, Capella University

WHETSTONE, JOHNA R. (2023)  
CONTINUING EDUCATION INTAKE SPECIALIST OF THE WORK  
EXPERIENCE PROGRAM (WEX)  
AA, Allegany College of Maryland  
BA, University of Maryland Global College

WHETSTONE, JULI S. (2018)  
INSTRUCTIONAL DESIGNER, eLEARNING & EDUCATION  
TECHNOLOGY SERVICES  
BS, Indiana University of Pennsylvania  
MA, Syracuse University

WILMES, TERESA B. (2002)  
COORDINATOR LIBRARY SERVICES  
MA, Jagiellonian University  
MLIS, University of Rhode Island

WILSON, LISA J. (1991)  
ASSISTANT DIRECTOR OF ADMISSIONS, RECORDS, AND  
INTERNATIONAL AFFAIRS  
Certificate, AA, Allegany College of Maryland  
BA, West Virginia University

WILT, BRANDON D. (2016)  
EDUCATION TECHNOLOGY AND MULTIMEDIA SPECIALIST  
AA, Allegany College of Maryland  
BS, Frostburg State University

WINTERBERG, LAUREN A. (2017)  
COORDINATOR OF STUDENT RECRUITMENT  
BA, Allegheny College

WOOD, MIHAELA A. (2011)  
DEAN OF ARTS AND SCIENCES  
BA, MA, University of Bucharest  
MA, PhD, University of Illinois  
Professor

YOKUM, ERIN K. (2005)  
DIRECTOR OF STUDENT AND RESIDENCE LIFE  
BA, Lebanon Valley College  
MA, Indiana University of Pennsylvania

YOUNG, DEREK B. (2008)  
ASSISTANT DIRECTOR OF STUDENT FINANCIAL AID PROGRAMS  
AS, Garrett College  
BS, Frostburg State University

ZIRK, CATHERINE M. (1998)  
DIRECTOR OF ACCOUNTING  
AA, Allegany College of Maryland  
BS, Frostburg State University

ZUCHELLI, BARBARA K. (1991)  
DIRECTOR OF EARLY COLLEGE  
BA, University of Pittsburgh at Johnstown  
MEd, Frostburg State University  
EdD, Indiana University of Pennsylvania

## PRESIDENT EMERITA

BAMBARA, CYNTHIA S. (2011-2024)  
PRESIDENT  
BS, Juniata College  
MEd, University of South Alabama

PhD, Colorado State University

## **ASSOCIATE SUPPORT STAFF**

---

ACKERMAN, JOHN P. (2022)  
ATHLETICS AND PHYSICAL EDUCATION, TECHNICIAN II  
BS, West Virginia University

BARCLAY, CHRISTINA G. (2012) (Part-time)  
FINANCE INVENTORY ADMINISTRATIVE ASSISTANT  
AA, Allegany College of Maryland

BECK, GEORGE H. (2016)  
CUSTODIAN, SECOND SHIFT

BENSON, SALLY A. (2018) (Part-time)  
ACCOUNTS RECEIVABLE BILLING SPECIALIST  
AA, Allegany College of Maryland

BITTINGER, DONNA T. (2023)  
ATHLETICS AND PHYSICAL EDUCATION TECHNICIAN I

BLUBAUGH, DAVID S. (2006)  
ATHLETICS AND PHYSICAL EDUCATION TECHNICIAN II

BOWERS, FRANK L. (2017) (Part-time)  
CUSTODIAN

BRIDGES, ELAINE S. (2001)  
ADMINISTRATIVE ASSOCIATE, MEDICAL LABORATORY TECHNOLOGY,  
PHLEBOTOMY/LABORATORY ASSISTANT, HUMAN SERVICE  
ASSOCIATE  
LOR, AAS, Allegany College of Maryland

BUCHANAN, DEBRA L. (2020) (Part-time)  
ADMINISTRATIVE ASSOCIATE, SCHOOL OF HOSPITALITY AND  
CULINARY ARTS  
AA, Allegany College of Maryland

BUSKIRK, PATRICK L. (2016)  
LAB TECHNICIAN, CUMBERLAND

CARNELL, MEGHAN (2023)  
ADMINISTRATIVE ASSOCIATE FOR RESPIRATORY THERAPY,  
MASSAGE THERAPY, DENTAL HYGIENE

CASE, TANNER R. (2023) (Part-time)  
SHREDDING TECHNICIAN

CERNAK, TIMOTHY B. (2022)  
CUSTODIAN, NIGHT SHIFT

CLITES, CAMILLA C. (2018) (Part-time)  
HOUSING & BUSINESS OFFICE ACCOUNT RECEIVABLE ASSISTANT  
AA, Allegany College of Maryland

CRAMER, EMILY M (2024) (Part-time)  
ADMINISTRATIVE ASSOCIATE, TECHNOLOGY SUITE  
AAS, Allegany College of Maryland

CREEGAN, ALEXANDER J. (2022)  
IT ASSOCIATE TECHNICIAN

DAVIS, KATELYN T. (2024)  
INTAKE AND STUDENT SUPPORT ASSOCIATE, PATHWAYS FOR  
SUCCESS (TRIO SS)

ANDRES, JAMIE A. (1989)  
ADMINISTRATIVE ASSOCIATE, OTA AND PTA PROGRAMS  
AA, Allegany College of Maryland

BAXTER, WILLIAM J. (2023) (Part-time)  
CUSTOMER SERVICE ASSOCIATE, MAKERSPACE  
BS, Frostburg State University

BENDER, COLTEN W. (2024) (Part-time)  
MAKERSPACE CUSTOMER SERVICE ASSOCIATE  
AA, Allegany College of Maryland

BISHOP, LEANDRA M. (2019) (Part-time)  
LIBRARY SERVICE ASSISTANT  
AA, Allegany College of Maryland

BLANK, PAUL F. (2018)  
CUSTODIAN, NIGHT SHIFT SUPERVISOR

BONE, JENNIFER F. (2022)  
ADMINISTRATIVE ASSOCIATE, CAREER PROGRAMS  
AA, Allegany College of Maryland

BRADLEY, JUSTIN M. (2022)  
CUSTODIAN, NIGHT SHIFT

BRISKEY, BARRY E. (2012) (Part-time)

CUSTODIAN

BURKETT, JENNA L. (2013)  
PRACTICUM COORDINATOR/MANAGER OF RESTAURANT  
OPERATIONS  
AA, Allegany College of Maryland  
BA, Frostburg State University

BYLER, LAUREN C. (2023) (Part-time)  
HUMAN RESOURCES RECRUITMENT AND PAYROLL ASSISTANT  
BS, Frostburg State University

CARRIER, AMBER (2024)  
ADMINISTRATIVE AND FACILITIES ASSOCIATE, CONTINUING  
EDUCATION AND WORKFORCE DEVELOPMENT

CASTO, TRACY L. (2023)  
CUSTODIAN, NIGHT SHIFT

CLAUSON, MARSHA L. (2007)  
ADMINISTRATIVE ASSOCIATE, BUSINESS AND ECONOMICS, FOREST  
TECHNOLOGY, MULTIMEDIA TECHNOLOGY, CRIMINAL JUSTICE AND  
LEGAL STUDIES  
AS, Allegany College of Maryland

COAKLEY, CONNIE M. (2002)  
ACCOUNTS PAYABLE SPECIALIST  
AS, Allegany College of Maryland

CRASS, GEORGE C. (2017)  
IT LEAD TECHNICIAN  
AAS, Allegany College of Maryland

DAVIS, DUSTIN P. (2021) (Part-time)  
MAKERSPACE TECHNICIAN

DAYTON, ANNETTE J. (2023)  
STUDENT INTAKE SPECIALIST  
AA, Allegany College of Maryland

BS, Frostburg State University

DEFRANCO, MADISON A. (2023)  
ENROLLMENT SERVICES GENERALIST  
AA, Allegany College of Maryland

DIEHL, CAITLIN A. (2023) (Part-time)  
CREATIVE SPECIALIST  
AA, Allegany College of Maryland  
BS, Frostburg State University

EDWARDS, ALEXANDRA (2023) (Part-time)  
MAKERSPACE TECHNICIAN

FISCUS, ADRON J. (2024) (Part-time)  
MAKERSPACE CUSTOMER SERVICE ASSOCIATE  
AA, Allegany College of Maryland

FOREMAN, SANDRA L. (2000)  
FOUNDATION SERVICES COORDINATOR  
AS, Allegany College of Maryland  
BS, Potomac State College of West Virginia University

GACKI, MARGARET M. (2011)  
ADMINISTRATIVE ASSISTANT, LIBRARY  
BA, Marywood University

GILES, WILLIAM J. (2021)  
HUMAN RESOURCES BENEFITS ASSOCIATE  
BA, MS, McDaniel College

GOODWIN, CAROL A. (2024)  
HUMAN RESOURCES ASSISTANT AND ACTIVITIES COORDINATOR  
BS, Troy University

GREGORY, PATRICIA E. (2021) (Part-time)  
ADMINISTRATIVE ASSOCIATE, DISABILITY SERVICES  
BS, MBA, Frostburg State University

HARMAN, SAM G. (2015) (Part-time)  
SECURITY, WILLOWBROOK WOODS

HARTMAN, SUZANNE I. (2020)  
ADMINISTRATIVE ASSOCIATE, WESTERN MARYLAND WORKS  
AA, Allegany College of Maryland

HEDRICK, PAYTON A. (2022)  
CATERING AND CAFE PRODUCTION ASSISTANT

HIGSON, APRIL L. (1992)  
ADMINISTRATIVE ASSISTANT, ATHLETICS AND PHYSICAL EDUCATION  
DEPARTMENT  
AA, Allegany College of Maryland  
BS, Geneva College

HITE, BRYAN E. (2016)  
CUSTODIAN, WILLOWBROOK WOODS

HOPPERT, AMY D. (2022) (Part-time)  
THOMAS WELCOME CENTER SPECIALIST  
AA, Allegany College of Maryland

KEPHART, HEATHER L. (2022)  
ADVISING CENTER GENERALIST  
AA, Potomac State College

DELAUTER, MARY J. (2021) (Part-time)  
UTILITY CUSTODIAL SUPPORT, CULINAIRE CAFÉ

DOLLY, DALTON (2025) (Part-time)  
SECURITY, WILLOWBOKK WOODS  
AA, Mountwest Technical and Community College

EVANS, MARY C. (1997)  
REGISTRATION ASSOCIATE, CONTINUING EDUCATION  
AA, Allegany College of Maryland  
BS, Frostburg State University

FOOR, ALYSSA M. (2024) (Part-time)  
FOUNDATION AND COMMUNITY RELATIONS ASSISTANT, BEDFORD  
COUNTY CAMPUS  
AA, Allegany College of Maryland

FREEMAN, MICHAEL S. (2018)  
CUSTODIAN SUPERVISOR, BEDFORD COUNTY CAMPUS

GARLOCK, SR., JAMES R. (2005) (Part-time)  
SECURITY, CAMPUS  
Anne Arundel Community College Public Safety Academy

GLASSER, ERICA N. (2014) (Part-time)  
LIBRARY ASSISTANT FOR GOVERNMENT DOCUMENTS  
BA, Amherst College

GRACE, DWAYNE L. (2018) (Part-time)  
SECURITY, CAMPUS

HARDMAN, SCOTT L. (2017) (Part-time)  
GENERAL MAINTENANCE, GOUNDSKEEPER

HARTELL, GARY A. (1992)  
IT SPECIALIST  
AAS, AA, Allegany College of Maryland  
BS, Colorado Technical University  
MS, Kaplan University  
MS, American Public University System

HAYES, MICHAEL A. (2014)  
IT TECHNICIAN  
AA, ITT Tech  
AA, Empire Business College

HEINRICH, COLLEEN M. (2014)  
ADMINISTRATIVE ASSOCIATE TO DIRECTOR OF DENTAL HYGIENE  
AA, Allegany College of Maryland

HINOJOSA, ROBERTO J. (2022)  
SECURITY, CAMPUS

HOGARTY, ONA S. (2021)  
LEARNING SPECIALIST II

HUMBERTSON, SUSAN C. (2004)  
THOMAS WELCOME CENTER SUPERVISOR  
AA, Allegany College of Maryland

KIDWELL, BRANDON C. (2017)  
CAMPUS TECHNICIAN

LEE, JANNA L. (2007)  
SECRETARY, PHYSICAL PLANT  
AA, Allegany College of Maryland

LONG, SUSAN E. (2016)  
ACCOUNTS RECEIVABLE ASSISTANT  
AA, Allegany College of Maryland

LYNN, TONY (2023)  
IT HELPDESK TECHNICIAN

MATHEWS, BRENDA A. (1987)  
FACULTY/ADMINISTRATIVE ASSISTANT, HUMANITIES  
AA, Allegany College of Maryland

MCCORMICK, NANCY M. (2001)  
REGISTRATION SPECIALIST/OFFICE MANAGER, CONTINUING  
EDUCATION  
AA, Allegany College of Maryland

MCKINLEY, SOMERS W. (2021) (Part-time)  
MAILROOM TECHNICIAN  
AA, Allegany College of Maryland

MEDCALF, ELIZABETH (2024)  
ADMINISTRATIVE ASSOCIATE, WEX PROGRAM  
BA, Roanoke College  
MBA, Frostburg State University

MILLER, DONALD L. (2016)  
CUSTODIAN, NIGHT SHIFT

MILLS, ROBERTA M. (1998)  
OFFICE MANAGER, SCIENCE DIVISION AND AUTOMOTIVE  
TECHNOLOGY  
AAS, Allegany College of Maryland

NESS, CANDY (2024)  
ADMINISTRATIVE ASSOCIATE, CONTINUING EDUCATION AND  
WORKFORCE DEVELOPMENT  
BS, Shepherd University

PARMER, EDWARD R. (2023)  
MAKERSPACE CUSTOMER SERVICE ASSOCIATE AND TECHNICIAN

PENROD, STEPHEN E. (2024) (Part-time)  
SECURITY, WILLOWBROOK WOODS

PIPER, JUSTIN N. (2022) (Part-time)  
GROUNDSKEEPER

PRICE, DENNIS (2024) (Part-time)  
CUSTODIAN, BEDFORD COUNTY CAMPUS

RESH, STEVE F. (1986-2018; 2022) (Part-time)  
TRANSPORTATION  
BS, Pennsylvania State University  
MS, University of Maine

ROBINETTE, KOLYNN R. (2024)  
CUSTODIAN

ROLLINS, JENNIFER R. (2024)  
OFFICE MANAGER, NURSE MANAGED WELLNESS CLINIC  
AA, Allegany College of Maryland

LINDNER, ANDREW J. (2019)  
PRINT PRODUCTION SPECIALIST  
Journey Pressman Certification

LOUGH, JIM D. (2012) (Part-time)  
SECURITY, CAMPUS  
Maryland Correctional Training Academy

MARTIN, JESSICA E. (1998)  
LIBRARY ASSISTANT FOR ACQUISITIONS AND TECHNICAL SERVICES  
AA, Allegany College of Maryland  
BS, Frostburg State University

MCBRIDE, TOMMY W. (2001)  
CUSTODIAN

MCCUSKER, LEIGH A. (2023) (Part-time)  
CAMPUS STORE ASSOCIATE

MCQUADE, SHAUNA N. (2002)  
EXECUTIVE ASSOCIATE TO THE SENIOR VICE PRESIDENT OF  
INSTRUCTIONAL AND STUDENT AFFAIRS  
BS, Towson University  
MEd, Frostburg State University

MERRITT, WILLIAM (2023) (Part-time)  
SECURITY, CAMPUS

MILLER, SR., LEROY R. (2015)  
CUSTODIAN

MOORE, MICHELLE L. (2011) (Part-time)  
THOMAS WELCOME CENTER SPECIALIST

NOLAN, KEN E. (2012)  
LEAD PRINT PRODUCTION SPECIALIST  
AAS, Allegany College of Maryland

PARSONS, STEVE A. (2023)  
CUSTODIAN, THIRD SHIFT  
AS, Allegany College of Maryland  
BS, Frostburg State University

PETRILLA, LEONARD (2011)  
BUS DRIVER/TECHNICIAN, TRANSPORTATION

PIPER, PAULA E. (2023) (Part-time)  
SECURITY, WILLOWBROOK WOODS

PYLES, ROBERT F. (2023) (Part-time)  
SECURITY, WILLOWBROOK WOODS  
AA, Allegany College of Maryland  
BS, Frostburg State University

RILEY, KARA M. (2000)  
ADMINISTRATIVE ASSISTANT, INFORMATION TECHNOLOGY  
DEPARTMENT  
AA, Allegany College of Maryland

ROCKWELL, ELIZABETH A. (2018)  
CAMPUS STORE ASSOCIATE II  
AA, Allegany College of Maryland

ROWAN, DEBORAH A. (2018) (Part-time)  
FACILITIES ASSISTANT, CONTINUING EDUCATION



RUBY, ROBERT L. (2024) (Part-time)  
DRIVER/MAIL COURIER  
AA, Allegany College of Maryland

RYAN, REBECCA S. (1991) (Part-time)  
ADMINISTRATIVE ASSOCIATE ALLIED HEALTH TECHNICIAN  
PROGRAMS  
AA, Allegany College of Maryland

SCHWENNINGER, SAMUEL J. (2016)  
IT ASSOCIATE TECHNICIAN  
AS, Allegany College of Maryland  
Master Certificate, Clark University

SHROUT, ROBERT J. (2021)  
CUSTODIAN, NIGHT SHIFT

SLOANE, HEATHER J. (2022)  
ADMINISTRATIVE ASSOCIATE OF NURSING PROGRAM  
AA, Allegany College of Maryland

SMYLY, SAM (2024)  
WESTERN MARYLAND WORKS FACILITIES TECHNICIAN

STAGGS, MARSHA L. (1989)  
IT ASSOCIATE TECHNICIAN  
BS, Frostburg State University

STEELE, MARTHA L. (2000)  
ASSISTANT REGISTRATION SPECIALIST, CONTINUING EDUCATION  
AA, Allegany College of Maryland

STITCHER, TASHA R. (2023)  
LEAD MAILROOM TECHNICIAN  
BS, Frostburg State University

TAYLOR, GARY L. (2021) (Part-time)  
CUSTOMER SERVICE ASSOCIATE AND TECHNICIAN, MAKERSPACE

TICE, ISAAC G. (2023)  
EDUCATION TECHNOLOGY SUPPORT TECHNICIAN  
AS, Eastern Mennonite University  
BS, Hesston College

VANMETER, LONALD R. (2004)  
GROUNDS/CUSTODIAN

WAGONER, TRISHA L. (2022)  
FINANCIAL AID SERVICES SPECIALIST  
AA, Allegany College of Maryland

WARNER, SAMUEL E. (2022)  
CUSTODIAN, NIGHT SHIFT

WILHELM, LARRY O. (2005)  
CAMPUS TECHNICIAN

WILLIS, GARY A. (2021) (Part-time)  
CUSTODIAN

WOLFE, ALLISON E. (2025)  
CAFE AND CATERING PRODUCTION ASSISTANT  
AA, Allegany College of Maryland

RUSSELL, JOHN A. (2024) (Part-time)  
SECURITY, WILLOWBROOK WOODS

SCHLERETH, IAN J. (2016)  
CUSTODIAN, NIGHT SHIFT

SHOOK, KATELIN (2024) (Part-time)  
ACCOUNTS RECEIVABLE ASSISTANT  
AA, Allegany College of Maryland

SINDY, J. GARY (2015) (Part-time)  
SECURITY, WILLOWBROOK WOODS  
BS, Frostburg State University

SMITH, CHARLENE A. (1978) (Part-time)  
ADMINISTRATIVE ASSISTANT TO THE VICE PRESIDENT OF FINANCE  
AND ADMINISTRATION  
AA, Allegany College of Maryland

SNYDER, MATTHEW L. (1993)  
LIBRARY ASSISTANT FOR INTERLIBRARY LOAN, CIRCULATION AND  
TECHNICAL SERVICES  
AA, Allegany College of Maryland

STAYER, ROBIN C. (2020)  
ADMINISTRATIVE ASSOCIATE, LPN-RN ONLINE PROGRAM

STEIN, LOUISE A. (2004)  
FINANCIAL AID SERVICES ASSOCIATE  
AA, Allegany College of Maryland

STONESTREET, DANIELLE A. (2007) (Part-time)  
OFFICE ASSISTANT, AUTOMOTIVE TECHNOLOGY AND  
TRANSPORTATION  
AA, Allegany College of Maryland

THOMPSON, KRISTA R. (1992) (Part-time)  
LAB TECHNICIAN I  
AA, Allegany College of Maryland

UMSTOT, DIANA L. (2017) (Part-time)  
ADMINISTRATIVE ASSOCIATE, CAREER AND EMPLOYER SOLUTIONS  
AA, Allegany College of Maryland  
BS, Frostburg State University

VOGEL, ROGER L. (2016)  
TESTING COORDINATOR  
BA, University of Pittsburgh, Johnstown

WALKER, SR, DAVE L. (2007)  
CAMPUS TECHNICIAN

WEICHT, AMY J. (2000)  
ADMINISTRATIVE ASSOCIATE FOR WORKFORCE DEVELOPMENT (PA)  
AAS, Allegany College of Maryland

WILLIAMS, MARIE W. (2019)  
PRINT AND MAIL SERVICES MANAGER  
AAS, Allegany College of Maryland

WILSON, SHIRLEY R. (1988)  
TUTORING COORDINATOR  
AAS, Allegany College of Maryland  
BS, MS, Geneva College

YOST-RUSHTON, MARY (2023) (Part-time)  
ADMINISTRATIVE ASSOCIATE, GATEWAY CENTER  
BS, DeSales University

MS, University of Connecticut

## PART-TIME FACULTY

BEAL, ELI R.  
BIOLOGY  
BS, Indiana University of PA  
MS, University of North Florida

BLANK, LEESA A.  
EDUCATION  
BS, Kent State University  
MS, Frostburg State University

BRADY, JASON P.  
ENGLISH AND PHILOSOPHY  
BA, Frostburg State University  
MA, Hood College

BRIGHT, ROBERT E.  
CRIMINAL JUSTICE  
BS, Marshall University

CARR, JUDY L.  
GEOGRAPHY  
BA, University of Pittsburgh at Johnstown  
MSW, The Ohio State University

CLEM, AMY L.  
DENTAL HYGIENE  
AAS, Allegany College of Maryland  
RDH

CRAMER, JADON J.  
ENGINEERING & ADVANCED MANUFACTURING  
AA, Pennsylvania Highlands Community College  
BS, Indiana University of Pennsylvania

CURLEY, MICHAEL S.  
PHYSICAL THERAPIST ASSISTANT  
AAS, Allegany College of Maryland  
BS, The Pennsylvania State University

DEAL, AMANDA J.  
BIOLOGY  
BS, Alderson-Broaddus College  
MS, Frostburg State University

EDWARDS, TRACY L.  
CULTURAL GEOGRAPHY  
BS, Frostburg State University  
MA, Syracuse University

FICKES, PATRICIA D.  
BEHAVIORAL AND SOCIAL SCIENCES  
BS, University of Pittsburgh  
BA, MS, DEd, The Pennsylvania State University

GOMBITA, EMILY L.  
PHYSICAL THERAPIST ASSISTANT

HANDERA, HALEY S.  
NURSING  
AS, Allegany College of Maryland  
BSN, Western Governors University

HAY, CYNTHIA D.

BEER, JOSEPH M.  
HISTORY  
BS, University of Cincinnati  
MS, PhD, Lancaster Theological Seminary

BOWMAN, LYNN G.  
ENGLISH/SPEECH  
BA, St. Mary's College of Maryland  
MA, University of Maryland, College Park  
Additional graduate study at University of Maryland, College Park

BRADY, WILLIAM P.  
BUSINESS ADMINISTRATION  
BA, University of Pittsburgh  
MBA, Frostburg State University

BUSKIRK, DENNIS C.  
COMPUTER TECHNOLOGY  
AA, Allegany College of Maryland  
BS, MBA, Frostburg State University  
Graduate study at West Virginia University

CASTLE, BRENDA L.  
ALLIED HEALTH TECHNICIAN PROGRAMS/NURSING ASSISTANT/  
GERIATRIC AIDE  
AA, Allegany College of Maryland  
RN

COLLINS-SMITH, CHRISTINA D.  
INTEGRATIVE HEALTH AND PHYSICAL EDUCATION  
BA, MA, McDaniel College

CRAWFORD, MATTHEW J.  
CHEMISTRY  
BS, Frostburg State University  
PhD, Carnegie Mellon University

DALEY, TIERRA L.  
NURSING  
AS, Allegany College of Maryland  
BSN, American Sentinel University  
MSN, Capella University

DOM, SUSAN L.  
DENTAL HYGIENE  
AA, Allegany College of Maryland  
RDH

HEATHER EMERICK  
PHLEBOTOMY/LABORATORY ASSISTANT  
AAS, Allegany College of Maryland

FOST, SHELBY S.  
NURSING ASSISTANT/GERIATRIC AIDE  
AA, Allegany College of Maryland

GROSS, BRIANNE N.  
DENTAL HYGIENE  
AAS, Allegany College of Maryland

HARMAN, BRITTANY  
SOCIOLOGY  
MS, Shippensburg University  
PhD, Stony Brook University

HAYNES-MCMULLEN, STEPHANIE N.  
OCCUPATIONAL THERAPY ASSISTANT

PSYCHOLOGY

AAS Allegany College of Maryland  
BFA, Frostburg State University  
COTA/L

HERB, PAUL A.  
FORESTRY

HILLIKER, BETH A.  
MASSAGE THERAPY  
AAS, Allegany College of Maryland

HOOVER, EVA T.  
SPANISH  
BA, Universidad Albert Einstein  
MA, Universidad Politencnia de Madrid

JEFFRIES, CLARK D.  
DENTAL HYGIENE  
Cedarville University  
West Virginia University School of Dentistry  
DDS

KISNER, BRYAN W.  
HISTORY

LITTEN, MELODY L.  
MEDICAL LABORATORY TECHNICIAN  
AA, Allegany College of Maryland

LOGSDON, BYRON A.  
RESPIRATORY THERAPIST  
AA, Allegany College of Maryland

MALONE, SARAH J.  
MATHEMATICS/EDUCATION  
BA, MA, West Virginia University

MCDOWELL, DONALD K.  
NURSING  
BS, University of Maryland Global Campus

MCELFISH, SHAWNEE L.  
EDUCATION  
AA, Allegany College of Maryland  
BS, MA, Frostburg State University

MC GEE-CUTTER, ROBIN L.  
ALLIED HEALTH TECHNICIAN PROGRAMS/NURSING ASSISTANT/  
GERIATRIC AIDE  
AA, Allegany College of Maryland  
RN

MCKENZIE, KIMBERLY  
LEARNING SPECIALIST  
BA, University of Pittsburgh Johnstown

MCMULLIN, ELIZABETH  
ENGLISH  
BS, Lock Haven University in Pennsylvania  
MSEd, Cannon University of Erie Pennsylvania

MELMED, BEVERLY M.  
RESPIRATORY THERAPIST  
AA, Allegany College of Maryland

MEYER, CHRIS L.  
COMPUTER SCIENCE AND TECHNOLOGY  
BS, Duquesne University  
MS, California University of Pennsylvania

MORRAL, KAITLYN A.  
NURSING  
AA, Allegany College of Maryland  
MS, Chamberlain College

NELSON, CHERYL K.  
NURSE MANAGED WELLNESS CLINIC  
AA, Allegany College of Maryland  
BSN, MSN, Shenandoah University  
Post-Master's Certificate Women's Health, West Virginia University  
DNP, Johns Hopkins University  
RN, FNP-BC, WHNP-BC

NEVINS, JULIANA  
ENGLISH  
BS, Saint Francis University  
MS, New Mexico State University

NICHOLS, D. SHANNON  
ART  
BFA, Frostburg State University

ORNDOFF, JESSICA  
PSYCHOLOGY  
BS, Towson University  
MS, University of Maryland

OVER, S. KELLY  
SOCIOLOGY  
BS, MEd, The Pennsylvania State University

OWENS, BRENDA L.  
NURSING  
AA, Allegany College of Maryland  
BSN, Indiana University of Pennsylvania  
MS, University of Pittsburgh  
RN, FNP-BC  
DNP, John Hopkins University

PHILLIPS, LISA A.  
SOCIOLOGY  
BS, University of Pittsburgh Johnstown  
MS, Duquesne University

POLAND, WILLIAM H.  
ENGINEERING & ADVANCED MANUFACTURING TECHNOLOGY

PRITTS, MARIAH E.  
BIOLOGY  
BS, Frostburg State University

PROSSER, ROBERT W.  
ENGINEERING & ADVANCED MANUFACTURING TECHNOLOGY

REED, ROBERT L.  
ALLIED HEALTH

RICHMOND, BRIAN D.F.  
MASSAGE THERAPY

BS, Frostburg State University

RITCHEY, JARED L.  
MULTIMEDIA TECHNOLOGY  
AAS, Allegany College of Maryland  
BA, Frostburg State University  
MET, Boise State University

ROUNDS, ADAM G.  
ALLIED HEALTH  
AA, Garrett College

SANTOS, ANTHONY R.  
RESPIRATORY THERAPIST  
AA, Allegany College of Maryland  
BS, Penn State University

SEIFARTH, JEAN M.  
NURSING  
BSN, Towson University  
MSN, University of Maryland  
PhD, West Virginia University

SHROUT, WILLIAM B.  
PHILOSOPHY AND SPEECH  
BA, Southeastern University  
MS, PhD, Liberty University

SLOPE, BRIAN D.  
COMPUTER TECHNOLOGY  
BS, Pennsylvania State University  
MEd, Walden University  
Additional graduate study at DeSales University, California University of PA,  
and Southern New Hampshire University

SMITH, RAE ANN  
PSYCHOLOGY  
AA, Allegany College of Maryland  
BS, Towson University  
BS, MEd, Frostburg State University  
OTD, University of St. Augustine  
OTR/L

STEWART, LOGAN  
ATHLETICS AND PHYSICAL EDUCATION  
BS, Frostburg State University

STONESTREET, REGINA C.  
MASSAGE THERAPY TEACHING ASSISTANT

TABORA, JOSHUA  
FORESTRY  
BS, Frostburg State University

VOGEL, MELANIE J.  
DENTAL HYGIENE  
AAS, Allegany College of Maryland  
BA, West Virginia University  
RDH

WATKINS, ALLISON K.  
MASSAGE THERAPY  
AS, Allegany College of Maryland  
BS, Frostburg State University

MS, University North Carolina

ROBINETTE, NICOLE M.  
ENGLISH  
BS, Wagner College  
MEd, Saint Francis University  
EdD Walden University

SANGIOVANNI, ANNE MARIE  
LEGAL STUDIES/CRIMINAL JUSTICE  
AA, Allegany College of Maryland  
BS, University of Maryland University College

SAVAGE, DEBRA L.  
NURSING ASSISTANT/GERIATRIC AIDE  
AA, Allegany College of Maryland

SHIPE, BEVERLY S.  
NURSING  
AS, Allegany College of Maryland  
BSN, Grand Canyon University  
MSN, Frostburg State University

SHROYER, CARRIE A.  
PSYCHOLOGY  
AS, Allegany College of Maryland  
BS, Southern New Hampshire University

SMITH, MELISSA  
MASSAGE  
AAS, Allegany College of Maryland

SNYDER, CHERIE L.  
HUMAN SERVICE  
BA, Dickinson College  
MA, Pennsylvania State University

STICKLER, JAMES D.  
BIOLOGICAL SCIENCES/CHEMISTRY  
BS, West Virginia University  
MS, PhD, University of Kentucky  
BA, Morris Harvey College  
CAS, West Virginia College of Graduate Studies

SWAUGER, LISA K.  
PSYCHOLOGY/SOCIOLOGY  
AA, Allegany College of Maryland  
BS, Frostburg State University  
MSW, West Virginia University

THOMAS, RITA M.  
COMPUTER TECHNOLOGY  
AAS, Allegany College of Maryland  
BS, MEd, EdD, Frostburg State University

WALSH, PATRICK C.  
PHILOSOPHY  
BS, MEd, Slippery Rock University

ZUMBRUN, CYNTHIA M  
MEDICAL ADMINISTRATIVE ASSISTANT  
AA, Allegany College of Maryland  
BS, MEd, Frostburg State University

## **BOARD OF TRUSTEES**

---

Kim B. Leonard, Chair

Jane A. Belt, Vice Chair

Mirjhana Buck

Linda W. Buckel

Eugene T. Frazier

Michele Martz

James R. Pyles

Mr. David R. Jones, Secretary-Treasurer

## **CAMPUS LOCATIONS**

---

### **CUMBERLAND CAMPUS**

12401 Willowbrook Road, SE

Cumberland, MD 21502-2596

301-784-5000

301-784-5005 – Thomas Welcome Center

[www.allegany.edu](http://www.allegany.edu)

### **BEDFORD COUNTY CAMPUS**

18 North River Lane

Everett, PA 15537-1410

814-652-9528

[www.allegany.edu/bedford-county-campus](http://www.allegany.edu/bedford-county-campus)

### **BEDFORD COUNTY TECHNICAL CENTER**

195 Pennknoll Road

Everett, PA 15537-6946

814-623-2760

### **SCHOOL OF HOSPITALITY MANAGEMENT AND CULINARY ARTS**

The Culinaire Café/Gateway Center

110-114 Baltimore Street

Cumberland, MD 21502-2302

301-784-5406

[www.allegany.edu/school-of-hospitality-culinary](http://www.allegany.edu/school-of-hospitality-culinary)

### **GARRETT COUNTY NURSING SITE**

317 Pythian Avenue

Oakland, MD 21550-5111

301-334-0530

### **SOMERSET EDUCATION SITE**

Somerset County Technology Center

281 Technology Drive

Somerset, PA 15501-4309

814-445-9848

### **WESTERN MARYLAND IT CENTER OF EXCELLENCE**

12401 Willowbrook Road, SE

Cumberland, MD 21502-2596

Technology Building - Room T221  
301-784-5434

#### **WESTERN MARYLAND WORKS**

37 Lane Avenue  
LaVale, MD 21502-7012  
301-784-5077  
[www.allegany.edu/western-maryland-works](http://www.allegany.edu/western-maryland-works)

---

#### **CUMBERLAND CAMPUS**

The College had modest beginnings in the former Carver School on Frederick Street, where the first students were enrolled in September 1961. Today, the College has a "modern and spacious" campus in suburban Cumberland.

The 316-acre campus includes 15 buildings, which provide modern facilities for both credit and non-credit students. Facilities and equipment are consistent with and designed to maintain the high academic standards of the College. In addition to the Learning Commons-Library, Humanities, and Science Buildings, there is a College Center which houses the student lounge, dining facilities, theatre, Admissions and Registration, Financial Aid, Student and Legal Affairs, Institutional Research, Advising Center, Instructional Affairs, and the Business Office. The campus also includes a Physical Education Building, which houses a large gymnasium and fitness center. The Technology Building houses instructional and laboratory facilities for several of the career technology programs in addition to the Information Technology and eLearning and Education Technology Services departments. The Continuing Education and Workforce Development Building houses classrooms and meeting rooms for conferences, workshops, and seminars. The College's health programs are located in the Allied Health Building. The Automotive Technology Building houses the Automotive Technology program. The Advancement Building houses the ACM Foundation office, public relations, student recruitment, marketing departments, and the Campus Store.

#### **BEDFORD COUNTY CAMPUS**

In 1990 the College began offering evening classes in the Everett Area High School. Recognizing the need for daytime classes and expanded associate degree and certificate programs, the \$2.3 million Bedford County Campus facility was constructed and opened in 1994. The facility was originally funded by the Bedford County Commissioners, the Southern Tier Education Council, and the Commonwealth of Pennsylvania on land leased by the Everett Area School District. The Bedford County Regional Education Foundation has provided financial support to furnish the facility. The 19,500 square-foot facility located in Everett, Pennsylvania, houses ten classrooms including two computer labs and one distance learning classroom; nursing simulation lab; learning commons/conference room; student lounge; and faculty offices. Administrative offices on campus also include student services; testing lab; career planning; transfer advising; and Foundation. Most recently, \$1.5 million has been invested by the Southern Tier Education Council and the Bedford County Regional Education Foundation to replace campus facility HVAC systems, restore the roof, upgrade flooring and paint finishes, repave parking areas, and renovate restrooms.

#### **BEDFORD COUNTY TECHNICAL CENTER**

In 2000 an agreement was established between Allegany College of Maryland and the Bedford County Technical Center to create the ACM/BCTC PA Workforce Training Center where credit programs, continuing education and workforce development trainings are offered. The 25,000 square-foot facility offers a variety of technical training and education including automotive repair and PA inspection, building trades, welding, health technologies, cosmetology, culinary/hospitality and Ag/Biotech. A Bedford County Technical Center facility expansion added science classrooms and labs which ACM utilizes for both day and evening ACM science classes.

#### **GARRETT COUNTY NURSING SITE**

Allegany College of Maryland Nursing program has an off-site location in Oakland, Garrett County, Maryland. The site is behind Garrett Regional Medical Center (GRMC). This program started in 2008 at the request of GRMC. Students have class in a private setting. The building has a classroom, a campus lab, and a lounge area for students. This site has all the conveniences and learning opportunities offered at our other two campus locations. The program accepts 20 students every other year starting in the spring semester of odd years.

#### **GATEWAY CENTER/SCHOOL OF HOSPITALITY MANAGEMENT & CULINARY ARTS**

The Gateway Center, located at 110-114 Baltimore Street in downtown Cumberland, is a three-story, historic building that serves as the college's public profile off campus and a stronghold in the city's revitalization efforts. Retaining many of its original art deco design features, its first floor is home to the School of Hospitality Management and Culinary Arts and the Culinaire Cafe, a student-run restaurant. The building's second-floor houses administrative offices for the Culinaire Cafe and Community Trust, LLC. The Adult Education and Literary Services program at ACM is located on the building's second floor and office preparation for high school equivalency and literacy services for families, English as a second language services, as well as, workforce development skill-building courses. The program is funded by the Maryland Department of Labor and courses for Maryland residents are offered free of charge. The Work Experience Program is also housed in the Gateway Center on the third floor. The WEX (Work Experience) Program is a

collaboration between ACM and Maryland's Department of Social Services (DDS) to improve employability of recipients of services who are work-eligible and receiving Temporary Cash Assistance.

---

## **SOMERSET EDUCATION SITE**

The Somerset Education Site was established in 2017 in support of its Early College program, which offers college-level courses to high school students. This effort has enriched the secondary education curriculum in Somerset County for more than two decades. With the support of principals and school district superintendents, multiple Somerset County high schools host college-level courses for high school juniors and seniors to add to their regular academic curricula each semester.

In addition, open enrollment coursework is offered during the Fall and Spring semesters to students enrolled at the Cumberland or Bedford County campuses and the general public. ACM staff the local office, which is located at the Somerset County Technology Center on Technology Drive.

---

## **WESTERN MARYLAND IT CENTER OF EXCELLENCE**

The Western Maryland IT Center of Excellence focuses on educating and upskilling a local workforce to meet the demands of IT business retention, expansion, and attraction in the region. We offer a variety of in-demand industry credential training programs in cyber security, networking, IT project management, and service desk management. The Center also focuses on delivering related youth STEM opportunities in the field of coding and robotics. Additionally, the Center hosts their annual *Tech at the Gap* conference at Rocky Gap Casino Resort every October.

---

## **WESTERN MARYLAND WORKS**

Located four miles from the Cumberland campus in lower LaVale, Western Maryland Works at Allegany College of Maryland is a training facility that is leading the charge in a new era of advanced manufacturing and workforce development for the region. With its cutting-edge training in robotics, precision machining, welding, and more, WMW bridges the gap between education and industry application, partnering with the public and private sectors. This 33,000 square foot facility serves as an epicenter for research, hands-on learning, and entrepreneurship, fostering the future of manufacturing excellence in the region.

The adaptive space houses the College's A.A.S Engineering - Automated Manufacturing Technology degree, and non-credit continuing education and workforce development training programs, offers dedicated classroom and lab space for advanced manufacturing technology, including digital fabrication, industrial maintenance, machining, robotics, welding, and woodworking. Program participants can earn National Institute of Metalworking Skills (NIMS) certifications and other industry-recognized credentials while taking advantage of on-site technology, including CNC routers, plasma cutters, robotic arms and I-Pendants, 3D and garment printers, and a full woodworking shop among its many offerings. The college owned facility, supported by a variety of public and private partners, serves more than 10 rural and underserved communities in Maryland, West Virginia, and Pennsylvania with the intention of creating and retaining high-quality jobs.

ACM program students in other disciplines may utilize Western Maryland Works at Allegany College of Maryland's resources through course projects or independently through a Makerspace membership. Western Maryland Works at Allegany College of Maryland proudly partners with Allegany County Public Schools to offer high school juniors and seniors the opportunity to complete 39 college credits over two years in Engineering - Automated Manufacturing Technology while simultaneously earning up to 14 valuable industry-recognized credentials. Students will then be recognized by the State of Maryland with a CTE completer certification in Manufacturing Engineering Technology upon finishing high school.

CAMPUS MAP

CUMBERLAND CAMPUS MAP



ALLEGANY  
COLLEGE  
of  
MARYLAND

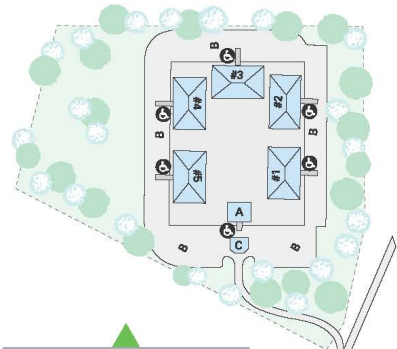

WILLOWBROOK WOODS  
Student Housing Complex

STUDENT HOUSING LEGEND

- 1 • Student Housing Building
- 2 • Student Housing Building
- 3 • Student Housing Building
- 4 • Student Housing Building
- 5 • Student Housing Building
- 6 • Student Housing Building
- A • Club House
- B • Parking
- C • Gatehouse
- Ⓒ • Handicap Parking



LEGEND			
AD	Advancement (Foundation, Public Relations, Marketing)	CS	Campus Store (Bookstore)
AH	Allied Health	H	Humanities
AT	Automotive Technology	L	Learning Commons
CC	College Center	LB	Labyrinth
CE	Continuing Education and Workforce Development	M	Maintenance
		PE	Physical Education / Gymnasium (Bob Kirk Arena)
		S	Science
		SG	Storage
		T	Technology
		TR	Transportation
		WB	Workforce Building
		WC	Thomas Welcome Center
		WCT	Western Region Correctional Training Center
		1-23	Parking
		Ⓒ	Handicap Parking

Financial Aid, Admissions/Registration, Advising Center, Business and Student Housing Offices are located in the College Center (CC). Ample parking is available, with reserved parking identified for the handicapped.

EQUAL EMPLOYMENT AND EDUCATIONAL OPPORTUNITIES

Allegany College of Maryland subscribes to and supports the following federal regulations governing equal employment and educational opportunities, as prescribed under law through the United States Department of Education:

Title VII of the Civil Rights Act of 1964 (as amended by the Equal Employment Opportunity Act of 1972).

Executive Order 11246 (as amended by Executive Order 11375).

The Equal Pay Act of 1963.

The Age Discrimination in Employment Act of 1967.

Title VI of the Civil Rights Act of 1964.



Title IX, Education Amendments Act of 1972.  
 Section 504 and 508 of the Rehabilitation Act of 1973.  
 Americans with Disabilities Act (ADA).  
 The Student Right To Know and Campus Security Act.

## FACILITIES

### DR. ROBERT ZIMMER COLLEGE THEATRE

The Dr. Robert Zimmer College Theatre is named for our founding president and located in College Center. It is home to all manner of college and community gatherings. Fully renovated in 2023, the Zimmer Theatre has 310 fixed seats, eight dedicated spaces for individuals who use wheelchairs, two retractable 128"x80" projection screens, and a state-of-the-art sound and LED light system and multimedia capabilities, with streaming and recording capabilities.

### GEORGE HAZEN ART GALLERY

To enrich the students' cultural background, the College maintains an art gallery in the College Center adjacent to the Dr. Ardell Haines Student Lounge. Managed by the Humanities Division, it offers a space to exhibit paintings, photographs, sculpture and other objects by tri-state area and student artists.

## PARKING

Unreserved parking is available for students. Staff parking is designated for use only by faculty and staff. Handicapped parking is designated for use only by persons with authorized handicapped tags/stickers. A Parking Permit is necessary and may be obtained at the Business Office. Violators will be fined. Parking fines are considered financial obligations to the College.

## SECURITY

Allegany College of Maryland is committed to ensuring a safe environment for students, faculty, staff and visitors. The Department of Campus Safety and Special Police, located at the Cumberland Campus, has primary responsibility for serving the safety and security needs of the campus community. Campus buildings and facilities are patrolled and inspected regularly to ensure a safe and comfortable academic environment. Every effort is made to fulfill any request for service. The Department realizes that security is also an individual responsibility and strives to educate the campus community about personal and public safety. The Department works closely with the administration, student services, housing and staff of the physical plant at all locations to ensure a safe environment. In addition, the Department works closely with the police and fire departments.

In order to maintain a safe environment for students to learn, for faculty to teach and for administration and staff to work, the Department of Campus Safety and Special Police is available twenty-four hours a day, seven days a week at the Cumberland Campus by calling **5555** from on campus or **301-784-5555** from off campus or by cell phone. This number can be called for emergencies or assistance at any time. Emergency Services (police, fire, ambulance, etc.) at any college location is always available by calling **911**. Clearly marked **EMERGENCY** telephones are located in designated buildings at the Cumberland Campus. The **EMERGENCY** telephones provide direct access to the Security Department (**5555**) or Emergency Services (**911**). The Director of Campus Security and Special Police is located in the Western Region Correctional Training Center. For additional information or to review our library of emergency videos, visit the college website at [www.allegany.edu/campus-safety-special-police](http://www.allegany.edu/campus-safety-special-police).

### THOMAS WELCOME CENTER

The Thomas Welcome Center, named after Dottie and Danny Thomas, is considered the front door of the Cumberland Campus. Housed in the Donald L. Alexander Learning Commons/Library, the Welcome Center provides an inviting atmosphere to prospective and current students, parents, donors, alumni, community members, and visitors. The Welcome Center includes a presentation room, lounge, and staff office. For more information regarding services provided by the Welcome Center, visit <https://allegany.edu/facilities/index.html>.

## FOUNDATIONS

### ALLEGANY COLLEGE OF MARYLAND FOUNDATION, INC.

#### BOARD OF DIRECTORS

Dr. Audie G. Klingler, *President*  
 Carl O. Belt, Jr., *Vice President*  
 Robert J. Martin, Jr., *Treasurer*  
 Elaine K. Solomon, *Secretary*  
 David N. Aydelotte, Sr.  
 Jonathan M. Dayton  
 Destinee Frankenberry  
 Bernie A. Friedland

Robert E. Heltzel  
Aaron W. Hendrickson  
Michael W. Kerns  
George W. Lapp, Jr.  
Chris T. Mathews  
Juli R. McCoy  
  
John J. McMullen, Jr.  
Matt Miller  
Mary Ann D. Moen  
Amanda W. Ruthenberg  
Judge J. Frederick Sharer  
Robert J. Smith  
John R. Smyth, Jr.

---

## **BOARD MEMBER EMERITUS**

Ivan A. Hall  
Dr. Gail O. Mazzocco  
  
John J. McMullen  
Miriam D. Sanner  
  
Gloria R. Saville  
Thomas R. Watters

Mr. David R. Jones  
*President, Allegany College of Maryland*

Courtney B. Jensen  
*Director of Grants and Development &  
Executive Director of the Allegany College of Maryland Foundation*

The Allegany College of Maryland Foundation is a not-for-profit foundation organized and incorporated under Maryland law. Its purpose is to receive private gifts, bequests and donations and to account for, manage, and help appreciate monies or property submitted to the Foundation or College. Such contributions are tax-deductible to the extent allowed by law. Funds for the Foundation are distributed to encourage and promote the growth, progress, and general welfare of Allegany College of Maryland.

The Foundation's Board of Directors comprises individuals who represent positive leadership and community influence and who have expressed an interest and desire to use their influence on behalf of the College through the Foundation.

The Foundation activities and support include, but are not limited to:

- Merit Scholarships for recognition of academic achievement;
- Scholarships for students with financial need;
- Development of regional and national interest in support of the College;
- Planning for special College activities and programs;
- Awards for special achievement; and
- Management and investment of funds.

Gifts to the Foundation may be made in any one of several ways and can usually be arranged to achieve maximum tax benefits to the donor while, at the same time, providing generous support to education. Contributions may be made by cash gifts, real or personal property, securities, provisions of a will, insurance policies, life income gifts, or establishing trusts. Gifts may be awarded for a specific purpose or given without restriction on use.

Persons interested in contributing to the Allegany College of Maryland Foundation, Inc. should contact any Foundation Board of Directors, their financial or legal representative, and/or the Foundation's Executive Director. Inquiries concerning the Allegany College of Maryland Foundation can be made by writing or calling:

### **Executive Director**

**Allegany College of Maryland Foundation, Inc.**  
**12401 Willowbrook Road, SE**  
**Cumberland, MD 21502-2596**  
**Phone: 301-784-5200**

---

## **BEDFORD COUNTY REGIONAL EDUCATIONAL FOUNDATION, INC.**

The Bedford County Regional Education Foundation was established as a non-profit foundation organized and incorporated under Pennsylvania law. The purpose of the foundation is to receive private gifts, bequests, and donations and to account for, manage and help appreciate monies or property submitted to the foundation or College. Such donations are tax-deductible to the extent allowed by law. Funds for the foundation are distributed to encourage and promote the growth, progress and general welfare of Allegany College of Maryland in Bedford County, Pennsylvania.

The Foundation activities and support include, but are not limited to:

- Scholarship support to students;
- Tuition assistance program for college-age and Early College students;
- Emergency book funding assistance;
- Bedford County Scholastic Hall of Fame;
- Management and investment of funds; and
- Development of campus facilities and infrastructure.

Gifts given to the Bedford County Regional Education Foundation assist students in reaching their dreams of postsecondary education. Contributions to the Foundation may support the scholarship endowment fund, establishment of new scholarship opportunities, Early College tuition assistance, emergency book funding, facility development, technology upgrades, a specific purpose, or given without restriction of use.

Persons interested in contributing to the Bedford County Regional Education Foundation should contact any of the Foundation members, their financial or legal representative, and/or the Director of PA Advancement and Community Relations. Inquiries concerning the Bedford County Regional Education Foundation may be made by calling or writing:

### **Bedford County Regional Education Foundation, Inc.**

**18 North River Lane**

**Everett, PA 15537**

**Phone: 814-652-9528**

---

## **BEDFORD COUNTY REGIONAL EDUCATION FOUNDATION BOARD OF DIRECTORS**

Dan Koontz, *Chair*

Beth Manges, *Vice Chair*

Kirt Morris, *Treasurer*

Lynn Ashe, *Secretary*

Todd Beatty

Deb Baughman

David Burkett

Connie Cragan

Craig Cutchall

Garry Goss

Meredith Hendershot

Cheryl McInroy

Dr. Christina Ramsey

Ralph Scott

Dr. William Shrout, Jr.

Larry Williams

Mr. David R. Jones

*President, Allegany College of Maryland*

Leah Pepple

*Director of PA Advancement and Community Relations*

---

## **BEDFORD COUNTY CAMPUS ADVISORY COMMITTEE**

The purpose and function of the Bedford County Campus Advisory Committee is to provide assistance and recommendations to the Board of Trustees and ACM administration concerning all aspects of the operation and development of the Bedford County Campus.

Larry Myers, *Chair*

Mike Eichelberger

Erin Geller

Kellie Goodman Shaffer

Jim Hollis  
Beth Hullihen  
Melissa Jacobs, *Vice Chair*  
Danielle Imes-Foor  
Dan Koontz  
Beth Manges  
Dr. Jennifer Nouse  
Mike O'Dellick  
Dr. Christina Ramsey  
Jill Reigh  
Dr. Paul Ruhlman  
Bette Slayton  
Denise Steele  
Larry Williams  
JR Winck

---

## HISTORY (THE COLLEGE)

Allegany College of Maryland was founded in August of 1961 by a resolution passed by the Allegany County Board of Education and approved by the Allegany County Commissioners. The College, which now has separate governance under a Board of Trustees, is an example of the rapid growth in the development of Maryland's community college system.

Allegany College of Maryland was established to provide low-cost, high quality, higher education for the residents of the area. Its accessibility to the county's center of population permits students to live at home, thus saving a substantial part of out-of-pocket costs for a college education.

Although heavy emphasis was placed on liberal arts transfer programs in the College's early development, in recent years the College has developed highly specialized curricula, including those in the technological and pre-professional areas, as career programs to satisfy identified needs of the region. Ever cognizant of its responsibility to an industrial area pocketed in Appalachian Western Maryland, Allegany College of Maryland has accepted a mission to make tangible contributions through higher education to the economic and cultural growth of the area. Through its Board of Trustees, the College presents a dimension of learning that prepares men and women for the excitement and satisfaction of creative lives.

---

## MISSION AND VISION

---

### GUIDING PRINCIPLES

- To provide convenient geographical access to post-secondary education to people within the service region of the college.
- To provide financial access to a college education by assuring reasonable tuition rates, comprehensive financial assistance, and college scholarship opportunities.
- To provide quality education and services, in a safe and comfortable environment, at a reasonable cost.
- To support an environment that promotes quality teaching and learning.
- To promote a college that enhances lives and the community through education and service.
- To instill in our students a philosophy of life-long learning.
- To foster a pro-learning campus environment that embraces the values of Allegany College of Maryland.
- To develop the technical competence and knowledge and other essential skills that prepare students for direct entry into the workforce, for career change and advancement, or for transfer to another college or university.
- To continually assess our programs and services in order to promote and encourage continuous improvement.

---

## MISSION

We deliver diverse and relevant education centered around student success in a supportive and engaging community.

---

## PHILOSOPHY

In developing and implementing the offerings of the College, the Board of Trustees, the faculty, and the staff have steadfastly held, and continue to hold, the following beliefs:

- We believe in democracy as a way of life, and in both the freedoms and responsibilities inherent in a democracy. We believe in preparation for active participation in a democracy.
- We believe that education is a process by which certain objectives of society are reached.
- We believe that education is sustained, utilized, and protected by society.

- We believe that our college, as an essential and integral part of the American way of life, has a direct relationship and responsibility to the community to serve as a leader in educational thought and practice. To this end, the educational resources of the institution are made available for use by the community.
- We believe that education embraces knowledge, training, and aspiration. Consequently, we believe in the dissemination of knowledge, the liberation of minds, the development of skills, the promotion of free inquiry, the encouragement of the creative or inventive spirit, and the establishment of wholesome attitude toward order and change, with an emphasis on ethical and legal concerns.
- We believe that we should educate broadly through a program of general education which introduces the students to the basic fields of knowledge: the arts and humanities, English composition, social and behavioral sciences, mathematics, and the biological and physical sciences.
- We believe that it is our responsibility to guide students in the exercise of self-direction and self-discipline in the solution of their problems, and to instill in them the desire to continue education as long as they live.
- We believe that knowledge alone is not enough. Ethics is indispensable; therefore, our program emphasizes appreciation of and response to beauty, truth, and justice, thus contributing to the general cultural development of the community through the individual.
- We believe in the cooperation of the College with all segments of its service area and in the continual evaluation of the College, its purpose and program, to the end that it may contribute to the maximum development of the individual and the area.

## VALUES

### Quality

We improve through assessment.

### Integrity

We promote honesty and trust.

### Respect

We foster dignity and worth.

### Opportunity

We provide innovative choices.

### Wellness

We promote healthy lifestyles.

## VISION

We will be the college of choice that transforms lives, strengthens communities, and makes learners the center of everything we do.

## POLICIES

### ALLEGANY COLLEGE OF MARYLAND OPEN DOOR ADMISSIONS POLICY

#### OUR DOOR IS OPEN

Allegany College of Maryland Open-Door Admissions Policy

Allegany College of Maryland strives to provide quality education and services in a safe and comfortable environment at a reasonable cost. Anyone who satisfies our admissions criteria, and who is at least sixteen years of age, is admitted to Allegany College of Maryland. ACM reserves the right to refuse admission or re-enrollment, or to place conditions on admission or re-enrollment, of applicants and former students who ACM determines represent a safety risk to students, faculty, or staff.

Admission to specific Associate degree or Certificate Programs requires at least a high school diploma or its equivalent. Allied Health Programs have special entrance requirements. Our Early College Program permits qualified high school students to enroll in some courses.

If you are interested in attending Allegany College of Maryland, see the Admissions Section of this catalog for more information.

### NON-DISCRIMINATION STATEMENT

Allegany College of Maryland does not discriminate on the basis of federally protected classes of race, color, national origin, religion, sex, age, disability, and veteran/military status in matters affecting employment or in providing access to programs and activities. Allegany College of Maryland recognizes and complies with additional protections for employees and/or pursuant to state law.

For inquiries related to this policy, Title IX, and ADA/504, please contact:

Dr. Renee Conner

Dean of Student and Legal Affairs

Title IX Coordinator

ADA/504 Coordinator  
301-784-5206 /rconner@allegany.edu

---

## **POLICY MANDATES**

---

### **TITLE IX**

Allegany College of Maryland prohibits sexual harassment and sex discrimination by or against all students and employees. If you have any questions or concerns or if you need to make a complaint, contact ACM's Title IX Coordinator, Dr. Renee Conner in CC-12, by email at [rconner@allegany.edu](mailto:rconner@allegany.edu), or by phone at (301) 784-5206. For detailed information about policy, procedures, and prevention education, see <https://allegany.edu/title-ix/index.html>

Prohibited behaviors include: sexual assault, stalking, relationship violence, quid quo pro sexual harassment, hostile environment sexual harassment, gender discrimination, and attempts to commit such acts.

---

### **CHILD ABUSE MANDATED REPORTS**

Allegany College of Maryland complies with Maryland law which requires all educators to report suspected child abuse. By law, educators are mandated reporters which means that if an educator suspects child abuse has occurred or if a person discloses that child abuse has occurred, the educator is required to make a report to Child Protective Services. A report must be made if regardless of when, where, or by whom the abuse occurred. For detailed information about Mandated Reporters including how to make a report, see here.

The College provides free counseling services. Also, the College's Title IX policy may also apply, so be sure to see the Title IX information.

---

### **CLERY ACT**

A report on Allegany College of Maryland's Campus Security Policies and Crime Statistics (34 CFR Part 668) and the Clery Act, 20 U.S.C. 1092 (a) and (b) in accordance with the FBI Uniform Crime Reporting (UCR)/National Incident-based Reporting System (NIBRS) is available in the Office of the Dean of Student & Legal Affairs (College Center, room CC-12) or through the Department of Campus Safety and Special Police webpage.

---

### **HEROIN & OPIOID POLICY**

Allegany College of Maryland recognizes drug and alcohol abuse/addiction as a health risk; the dangers associated with heroin and opioids are gravely concerning to this institution. The college urges everyone to be informed and offers educational resources (including treatment information). All new, full time students are required by Maryland law to participate in heroin/opioid training. In an overdose emergency, call 911. If you have any questions or concerns or if you need help, contact the Department of Campus Safety and Special Police by email or by phone at 301-784-5252 or the Office of Student & Legal Affairs by email, or by phone at 301-784-5206. \*Allegany College of Maryland prohibits the possession and use of drugs and alcohol on all college property and in all college-affiliated activities without the express permission of the College President.

---

### **DRUG AND ALCOHOL USE**

Allegany College of Maryland & Willowbrook Woods is a dry, clean, and clear campus.

Allegany College of Maryland supports the efforts of the State of Maryland and the United States to provide workplaces and learning centers free of illicit drug use and free of unlawful alcohol use. The College supports and complies with the Federal Drug-Free Workplace Act of 1988, the Federal Drug-Free Schools and Communities Act Amendments of 1989, and drug and alcohol abuse policies of the Maryland Higher Education Commission.

It is the College's intention to provide and maintain a work environment for employees and students that is drug-free, healthful, safe, and secure. When any person is on College property and/or participating in a College-sponsored or College-sanctioned activity, the person is expected to be free of any illegal drugs/alcohol and capable of fulfilling their responsibilities unimpaired by any substance. Although the College recognizes drug/alcohol dependency as an illness and a major health problem affecting society, it also recognizes drug use and activity as a potential health, safety, and security problem. Students and employees requiring assistance in dealing with drug or alcohol abuse or dependency are encouraged to seek treatment.

---

### **ACADEMIC DISABILITIES**

In compliance with federal ADA/504 requirements, Allegany College of Maryland supports the belief that all otherwise qualified citizens should have access to higher education and those individuals should not be excluded from this pursuit solely by reason of handicap. The College is committed to the inclusion of students with disabilities within all areas of college life. Therefore, support services are intended to maximize the independence and participation of disabled students. Further, the College complies with applicable state and federal laws and regulations prohibiting discrimination in the admission and treatment of students.

Any student who wishes to receive accommodations must register with the Academic Access & Disability Resources Office, providing documentation of the declared disability. Once documentation is received, the Director will establish eligibility for specific accommodations based on the student's documented functional limitations and the essential functions of each course. Any student who wishes to declare a disability should contact the Academic Access & Disability Resources office at 301-784-5234. For more information visit the Academic Access & Disability Resources webpage.

## **ADA/504**

---

American with Disabilities Act of 1990, Title II prohibits discrimination on the basis of disability; this legislation established comprehensive standards that were expanded per 2008 Amendments. Rehabilitation Act of 1972, Section 504 prohibits discrimination against any person on the basis of a "handicap" by entities receiving federal funds.

If you have a disability, we urge you to contact the appropriate office/person to request reasonable accommodations. You will need to complete some paperwork, provide documentation, and meet with the designated College Official who will help you with the process to determine the appropriate accommodations. For questions, referrals, or to file a complaint, contact ACM's ADA/504 Coordinator, Dr. Renee Conner in CC-12, by email at [rconner@allegany.edu](mailto:rconner@allegany.edu), or by phone at (301) 784-5206. For detailed information about policy, procedures, and prevention education, see <https://www.allegany.edu/student-and-legal-affairs/ada-504.html>

## **FERPA**

---

In compliance with the Family Educational Rights and Privacy Act of 1974, Allegany College of Maryland will not disclose any information from the students' educational records without the written consent of students except to personnel within the institution, to accrediting agencies carrying out their accreditation function, to persons in compliance with a judicial order, and to persons in an emergency in order to protect the health or safety of students, other persons, or other lawful exception. At its discretion, the institution may provide directory information to include: student name, address, email address, photo, dates of attendance, credentials earned, honors awarded, and alumni status. Students' rights, the College's obligations, and disclosure standards are detailed in the FERPA policy. View ACM's FERPA policy.

## **MEDICAL DISCLOSURE PROCEDURE**

---

Students are responsible for their own health and should always consult a qualified health care provider if a health or medical condition interferes with the students' ability to attend class in excess of what is permitted by the course syllabus or program requirements or to participate in an essential class function. Medically necessary absences will be excused with documentation from a qualified health care provider; students are responsible for contacting the instructor about if/how to complete any missed work. An information sheet with additional details is located on the Student and Legal Affairs webpage under both the Title IX tab and the ADA/504 tab.

## **FAITH-BASED/RELIGIOUS ACADEMIC ACCOMMODATIONS**

---

The College's two, companion First Amendment Policies detail how ACM honors constitutional protections for speech, expression, assembly, and religion. The second policy (effective 7/1/23) is ACM's First Amendment Religious Freedom Policy. It also codifies Maryland law which requires all faculty/programs to provide these academic accommodations for sincerely held faith-based/religious practices:

- excuse absences for a student to observe faith-based or religious holidays or participate in organized religious activities and
- allow an alternative if a student misses an examination or other academic requirement pursuant to an absence excused under this policy.

An information sheet with details is located on the Student and Legal Affairs webpage. Direct any questions or concerns/grievances to the Dean of Student and Legal Affairs by calling 301-784-5206.

## **STUDENT POPULATION**

---

Allegany College of Maryland students reflect the diversity of backgrounds and life-styles of its regional population. Most students live within a thirty-mile radius of one of the two campuses. The College welcomes the increasing number of veterans, homemakers, and employed adults seeking to upgrade job skills or contemplating career change.